

PAGE 1/2	ISSUE 30-07-25A	SERIES ADAPT	PART NUMBER RS19843000
----------	--------------------	--------------	-------------------------------

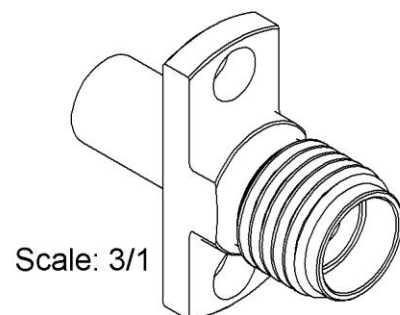

All dimensions are in mm. Tolerances according ISO 2768 m-H

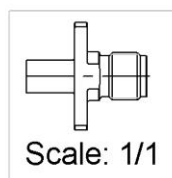
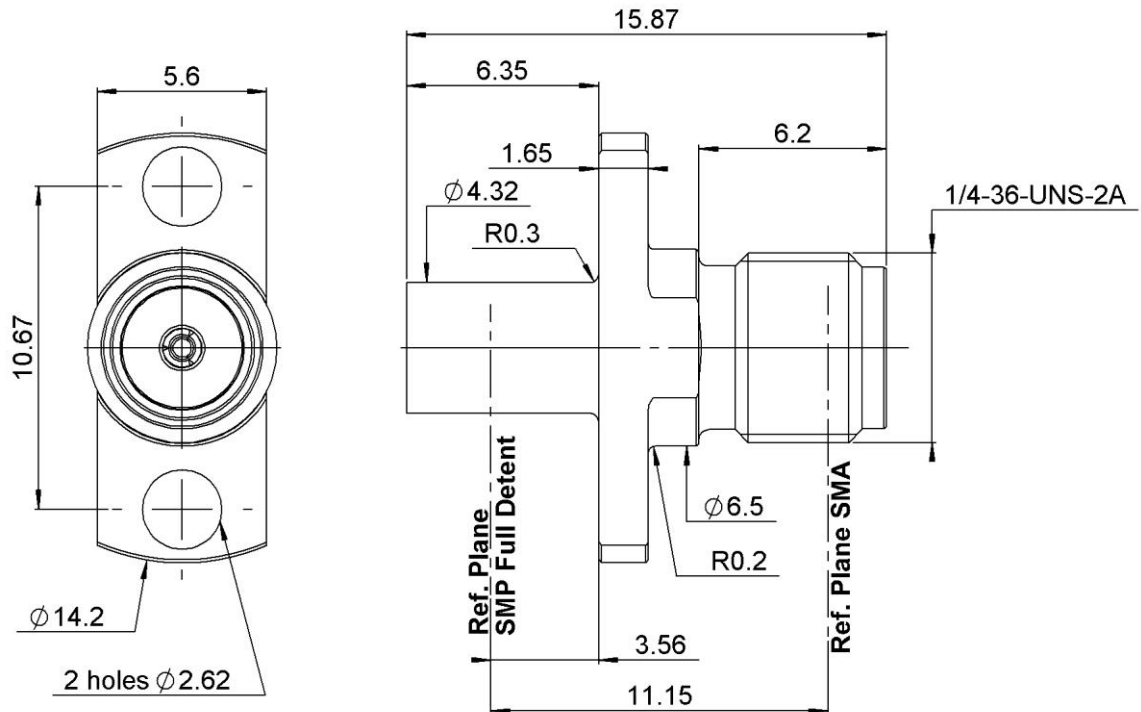
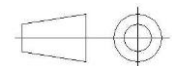

COMPONENTS	MATERIALS	PLATING (μm)
Body	STAINLESS STEEL	PASSIVATED
Center contact	BERYLLIUM COPPER	GOLD OVER NICKEL
Outer contact		-
Insulator	PTFE	-
Gasket	-	-
Others parts	-	-
-	-	-
-	-	-

PAGE 2/2	ISSUE 30-07-25A	SERIES ADAPT	PART NUMBER RS19843000
-----------------	---------------------------	---------------------	-------------------------------

PACKAGING

Standard	Unit	Other
1	Contact us	Contact us

ELECTRICAL CHARACTERISTICS

Impedance		50	Ω
Frequency		0-18	GHz
VSWR	1.3	+	0.0000 x F(GHz) Maxi
Insertion loss		0.02	\sqrt{F} (GHz) dB Maxi
RF leakage	- (NA	- F(GHz)) dB Maxi
Voltage rating		335	Veff Maxi
Dielectric withstanding voltage		500	Veff mini
Insulation resistance		5000	M Ω mini

MECHANICAL CHARACTERISTICS

Center contact retention			
Axial force – Mating End		6.8	N mini
Axial force – Opposite end		6.8	N mini
Torque		NA	N.cm mini
Recommended torque			
Mating	SMA	NA	N.cm
	SMP	NA	N.cm
		NA	N.cm
Panel nut		-	N.cm
Mating life		100	Cycles mini
Nominal weight (Add +15% for max weight)		2.3877	g

ENVIRONMENTAL

Operating	-65/+165	°C
Hermetic seal		Atm.cm3/s
Panel leakage		

SPECIFICATION

RAD-GEN-CONN-004

OTHER CHARACTERISTICS