

PAGE 1/2

ISSUE
14-08-25A

SERIES **SMA**

PART NUMBER **RS01415000**

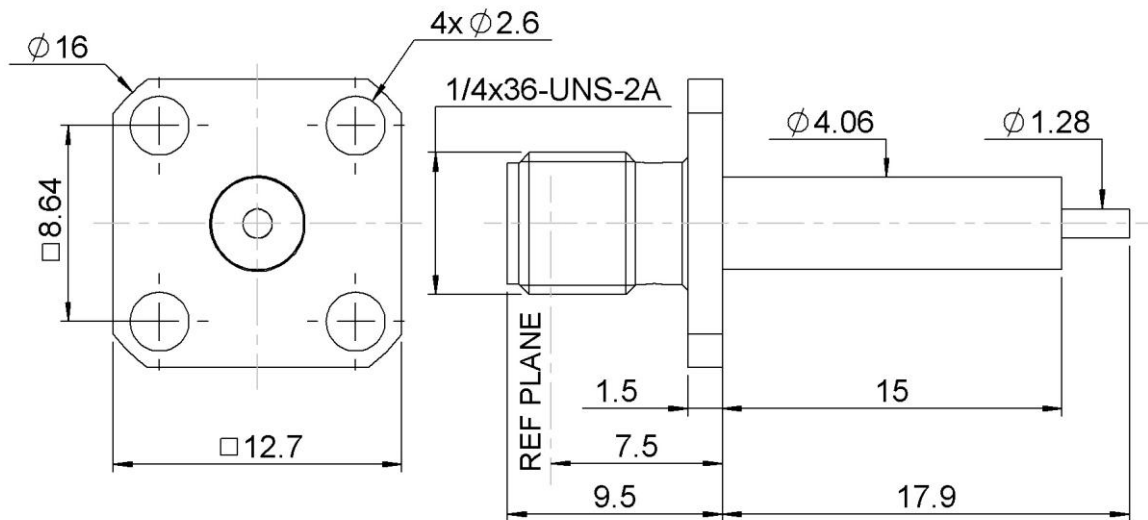

PANEL CUT OUT

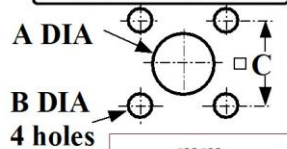

	mm	
	Maxi	mini
A	4.2	4.1
B	2.7	2.6
C	8.69	8.59

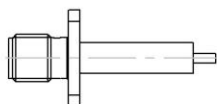

Scale : 1/1

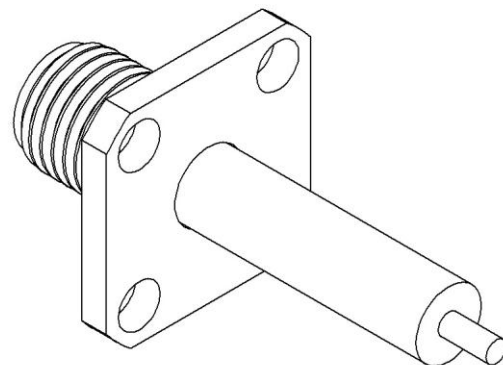

All dimensions are in mm. Tolerances according ISO 2768 m-H

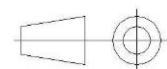

COMPONENTS	MATERIALS	PLATING (μm)
Body	STAINLESS STEEL	PASSIVATED
Center contact	BERYLLIUM COPPER	GOLD OVER NICKEL
Outer contact	-	-
Insulator	PTFE	-
Gasket	-	-
Others parts	-	-
-	-	-
-	-	-

PAGE 2/2	ISSUE 14-08-25A	SERIES SMA	PART NUMBER RS01415000
----------	--------------------	-------------------	-------------------------------

PACKAGING

Standard	Unit	Other
1	-	Contact us

ELECTRICAL CHARACTERISTICS

Impedance	50	Ω
Frequency	0-18	GHz
VSWR	1.06* + 0.0020	x F(GHz) Maxi
Insertion loss	0.02+0.07*	\sqrt{F} (GHz) dB Maxi
RF leakage	- (60	- F(GHz)) dB Maxi
Voltage rating	500	Veff Maxi
Dielectric withstanding voltage	1000	Veff mini
Insulation resistance	5000	M Ω mini

MECHANICAL CHARACTERISTICS

Center contact retention		
Axial force – Mating End	27	N mini
Axial force – Opposite end	27	N mini
Torque	2.8	N.cm mini

Recommended torque		
Mating	NA	N.cm
Panel nut	NA	N.cm

Mating life	500	Cycles mini
Nominal Weight	3.1094	g
(Add +15% for max weight)		

ENVIRONMENTAL

Operating temperature	-65/+165	°C
Hermetic seal	NA	Atm.cm3/s
Panel leakage	NA	

SPECIFICATION

RAD-GEN-CONN-004

OTHER CHARACTERISTICS

Assembly instruction: **NA**

Others:

* **Coaxial Transmission Line Only**

CUSTOMER APPROVAL

Company / department :

Name /date/signature :

Signed copy to be sent back to Radiall before any order.

Note : In case of compliant matrix, it must be signed and sent back too