

PAGE 1/2

ISSUE  
31-07-25A

SERIES **SMPM-L**

PART NUMBER **RS06L60000**

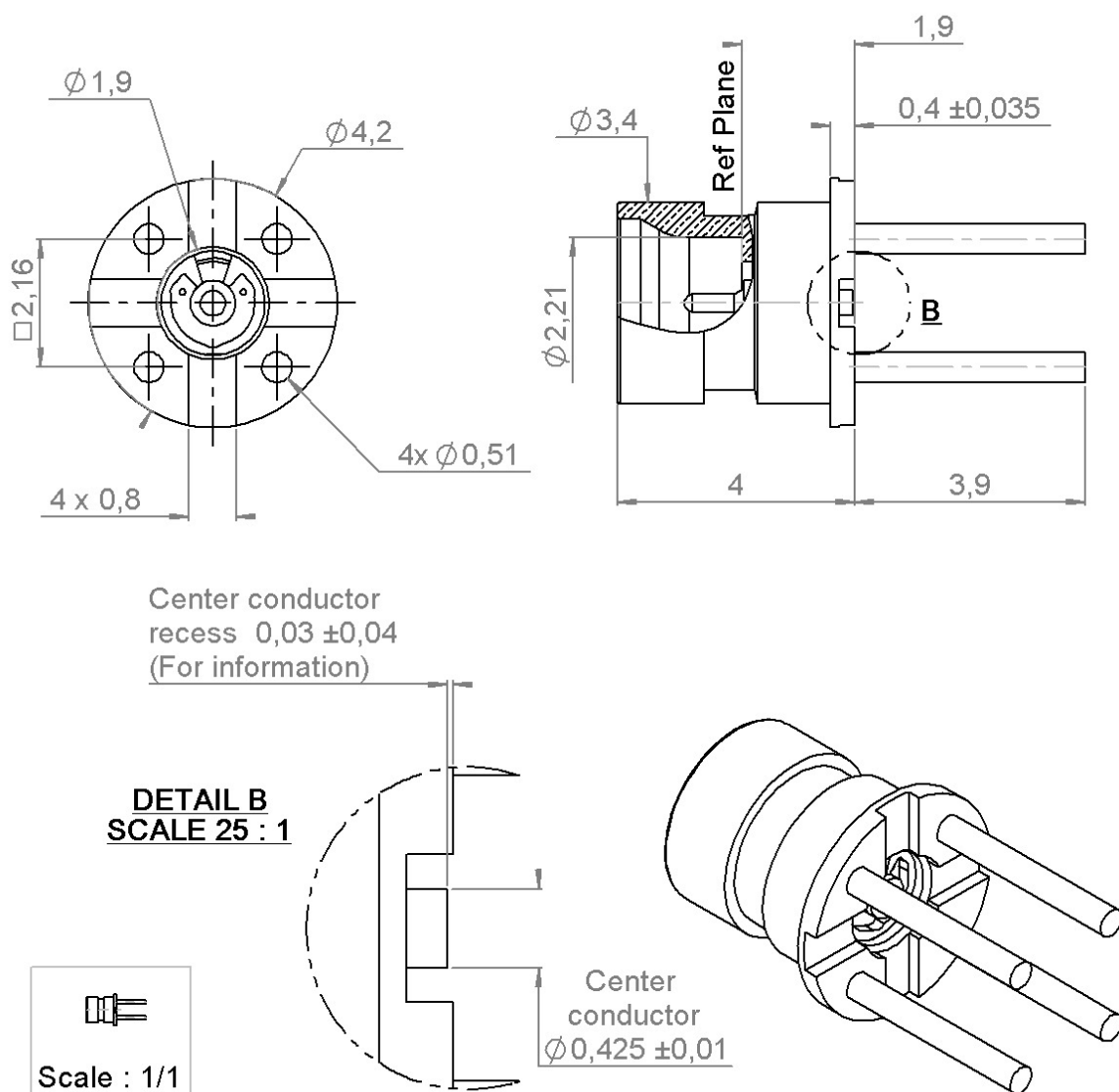

All dimensions are in mm. Tolerances according ISO 2768 m-H

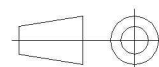

COMPONENTS	MATERIALS	PLATING (µm)
Body	<b>BERYLLIUM COPPER</b>	<b>N2PGR</b>
Center contact	<b>BERYLLIUM COPPER</b>	<b>N2PGR</b>
Outer contact	-	-
Insulator	<b>PEEK</b>	-
Gasket	-	-
Others parts	-	-
-	-	-
-	-	-

PAGE 2/2

ISSUE  
**31-07-25A**

SERIES **SMPM-L**

PART NUMBER **RS06L60000**

## PACKAGING

Standard	Unit	Other
<b>100</b>	<b>Contact us</b>	<b>Contact us</b>

## ELECTRICAL CHARACTERISTICS

Impedance	<b>50</b>	$\Omega$
Frequency	<b>0-65</b>	GHz
VSWR	<b>* 0,0000</b>	x F(GHz) Maxi
Insertion loss	<b>*0.12</b>	$\sqrt{F}$ (GHz) dB Maxi
RF leakage	<b>NA</b>	- F(GHz) dB Maxi
Voltage rating	<b>125</b>	Veff Maxi
Dielectric withstanding voltage	<b>250</b>	Veff mini
Insulation resistance	<b>5000</b>	M $\Omega$ mini

## MECHANICAL CHARACTERISTICS

Center contact retention		
Axial force – Mating End	<b>6.7</b>	N mini
Axial force – Opposite end	<b>6.7</b>	N mini
Torque	<b>NA</b>	N.cm mini

Recommended torque		
Mating	<b>NA</b>	N.cm
Panel nut	<b>NA</b>	N.cm

Mating life	<b>10</b>	Cycles mini
Nominal Weight (Add +15% for max weight)	<b>0,2200</b>	g

## ENVIRONMENTAL

Operating temperature	<b>-65/+165</b>	°C
Hermetic seal	<b>NA</b>	Atm.cm3/s
Panel leakage	<b>NA</b>	

## SPECIFICATION

RAD-GEN-CONN-006

## OTHER CHARACTERISTICS

Assembly instruction:

Others:

**\*1.15 to 12GHz // 1.35 to 20GHz**

**\*Coaxial transmission line only**

**\* Performance strongly depends on layout and PCB material**