

PAGE 1/2

ISSUE 2032A

SERIES SMA-S

PART NUMBER R126421011

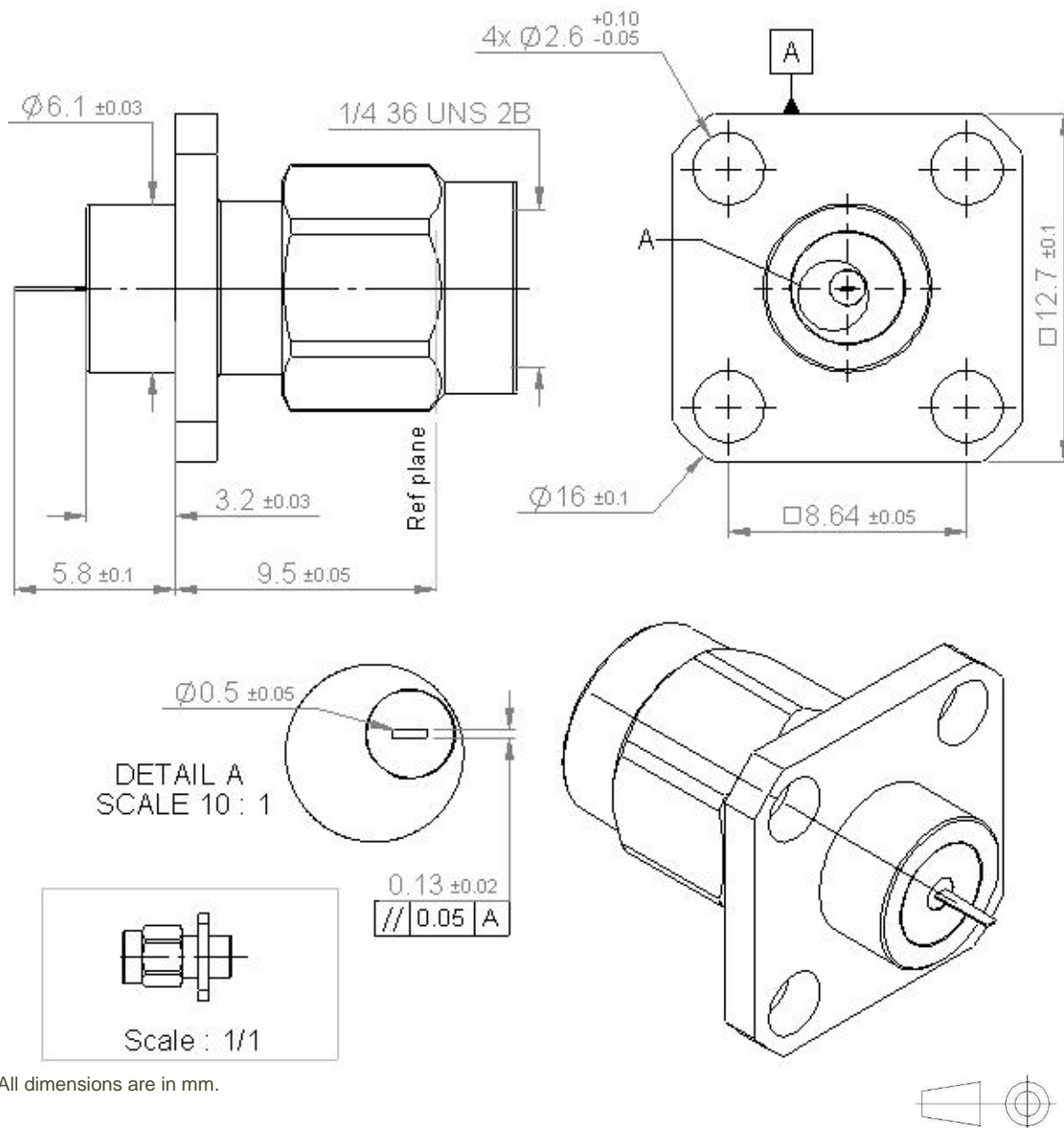

All dimensions are in mm.

COMPONENTS	MATERIALS	PLATING (μm)
Body	STAINLESS STEEL	PASSIVATED
Center contact	BERYLLIUM COPPER	GOLD 1.3 OVER NICKEL2
Outer contact	STAINLESS STEEL	PASSIVATED
Insulator	PTFE	
Gasket	SILICONE 60 SHORE A, RED	
Others parts	STAINLESS STEEL	PASSIVATED
-	-	-
-	-	-

PAGE 2/2

ISSUE 2032A

SERIES SMA-S

PART NUMBER R126421011

### PACKAGING

Standard	Unit	Other
1	-	Contact us

### ELECTRICAL CHARACTERISTICS

Impedance		50	Ω
Frequency		0-18	GHz
VSWR	1.1	+	0,0100 x F(GHz) Maxi
Insertion loss		0.02+0.05	√F(GHz) dB Maxi
RF leakage	- (	110	- F(GHz) dB Maxi
Voltage rating		335	Vrms Maxi
Dielectric withstanding voltage		1000	Vrms mini
Insulation resistance		5000	MΩ mini

### MECHANICAL CHARACTERISTICS

Center contact retention			
Axial force – Mating End		27	N mini
Axial force – Opposite end		27	N mini
Torque		2.8	N.cm mini
Recommended torque			
Mating		80-120	N.cm
Panel nut		NA	N.cm
Mating life		500	Cycles Maxi
Weight		5,5000	g Maxi

### ENVIRONMENTAL

Operating temperature	-65/ +105	°C
Hermetic seal	NA	Atm.cm3/s
Panel leakage	NA	

### SPECIFICATION

According to 3402  
According to 3402 001

### OTHER CHARACTERISTICS

Assembly instruction:

Others: