

PAGE 1/2	ISSUE 2028A	SERIES SMA-S	PART NUMBER R125154010X
----------	-------------	--------------	--------------------------------

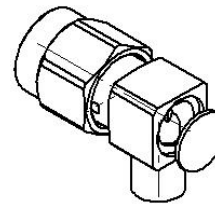

All dimensions are in mm.

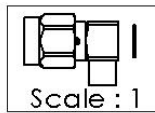
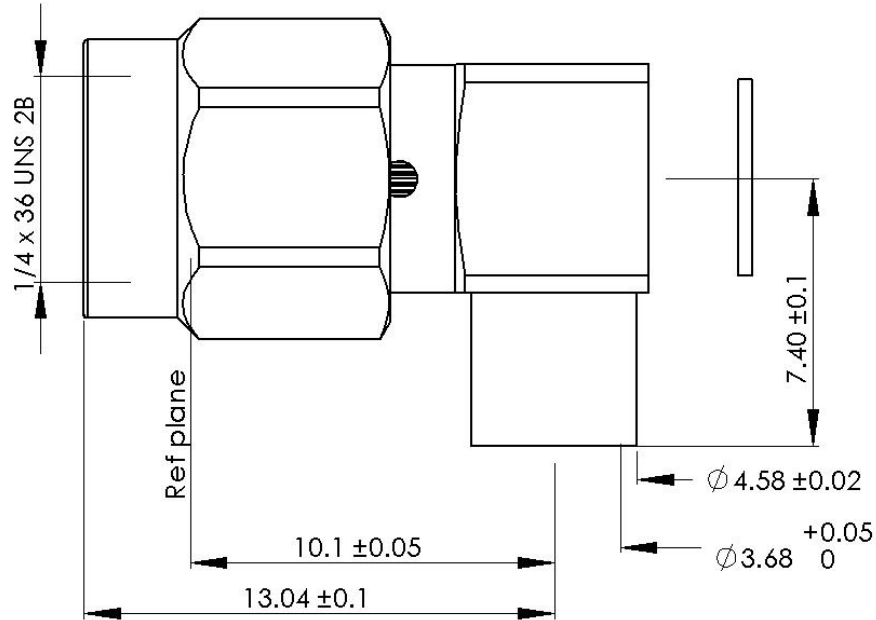
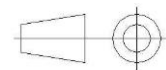

COMPONENTS	MATERIALS	PLATING (µm)
Body	INOX	GOLD 0.5 OVER NICKEL 2
Center contact	BRASS	GOLD 1.3 OVER NICKEL2
Outer contact	-	-
Insulator	PTFE	
Gasket	SILICONE RUBBER	
Others parts	BRASS	GOLD 0.2 OVER NICKEL 2
-	-	-
-	-	-

PAGE 2/2	ISSUE 2028A	SERIES SMA-S	PART NUMBER R125154010X
----------	--------------------	---------------------	--------------------------------

PACKAGING

Standard	Unit	Other
1	-	Contact us

ELECTRICAL CHARACTERISTICS

Impedance		50	Ω	
Frequency		0-12.4	GHz	
VSWR	1.1	+	0,0100	x F(GHz) Maxi
Insertion loss		0.02+0.05	√F(GHz) dB Maxi	
RF leakage	-	(-	- F(GHz)) dB Maxi
Voltage rating		335	Vrms Maxi	
Dielectric withstanding voltage		1000	Vrms mini	
Insulation resistance		5000	MΩ mini	

ENVIRONMENTAL

Operating temperature	-65/+165	°C
Hermetic seal	NA	Atm.cm3/s
Panel leakage	NA	

MECHANICAL CHARACTERISTICS

Center contact retention			
Axial force – Mating End		27	N mini
Axial force – Opposite end		27	N mini
Torque		NA	N.cm mini
Recommended torque			
Mating		80-120	N.cm
Panel nut		NA	N.cm
Mating life		500	Cycles Maxi
Weight		4,0000	g Maxi

SPECIFICATION

RAD-GEN-CONN 001
RAD-DET-CONN 002

OTHER CHARACTERISTICS

Assembly instruction:

Others: