

PAGE **1/2**

ISSUE **30.01.15**

SERIE : **SPnT**

PART NUMBER : **R573723400**

RF CHARACTERISTICS

Number of ways : **4**
 Frequency range : **0 - 26.5 GHz**
 Impedance : **50 Ohms**

Frequency (GHz)	DC - 6	6 - 12.4	12.4 - 18	18 - 26.5
VSWR max	1,30	1,40	1,50	1,70
Insertion loss max	0.20 dB	0.40 dB	0.50 dB	0.70 dB
Isolation min	70 dB	60 dB	60 dB	55 dB
Average power (*)	40 W	30 W	25 W	15 W

ELECTRICAL CHARACTERISTICS

Actuator : **LATCHING**
 Nominal current ** : **125 mA / RESET : 500 mA ******
 Actuator voltage (Vcc) : **28V (24 to 30V) / NEGATIVE COMMON**
 Terminals : **solder pins (250°C max. / 30 sec.)**

MECHANICAL CHARACTERISTICS

Connectors : **SMA 2.9 female per MIL-C 39012**
 Life : **2.000.000 cycles per position**
 Switching Time*** : **< 15 ms**
 Construction : **Splashproof**
 Weight : **< 180 g**

ENVIRONMENTAL CHARACTERISTICS

Operating temperature range : **-40°C to +85°C**
 Storage temperature range : **-55°C to +85°C**

(* Average power at 25°C per RF Path)

(** At 25° C ±10%)

(*** Nominal voltage ; 25° C)

(**** Reset : supply voltage time 1sec. max. / duty cycle 10%)



PAGE 2/2

ISSUE 30.01.15

SERIE : SPnT

PART NUMBER : R573723400

DRAWING

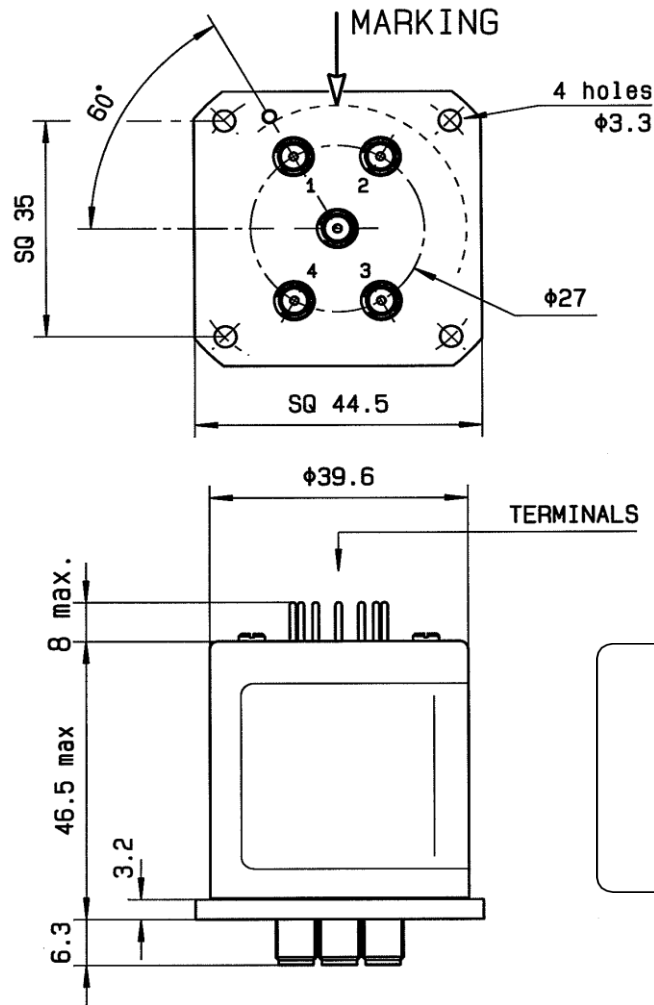

Voltage	RF Continuity
-C +RESET	All ports open
-C +1	IN ↔ 1
-C +2	IN ↔ 2
-C +3	IN ↔ 3
-C +4	IN ↔ 4

LABEL

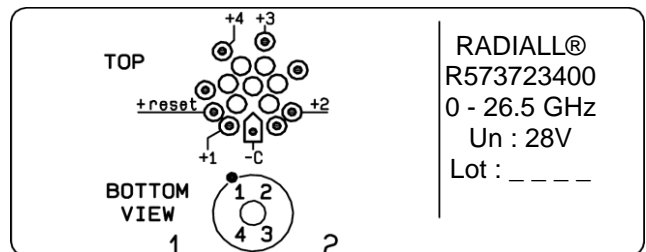

General tolerances : ± 0.5 mm

SCHEMATIC DIAGRAM

