

PAGE 1/2	ISSUE 19-01-26B	SERIES TERMINATION	PART NUMBER <b>R404370000</b>
----------	--------------------	-----------------------	-------------------------------

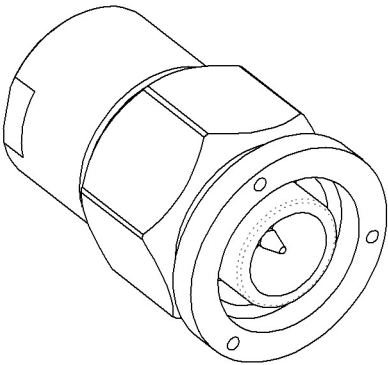

All dimensions are in mm. Tolerances according ISO 2768 c-K

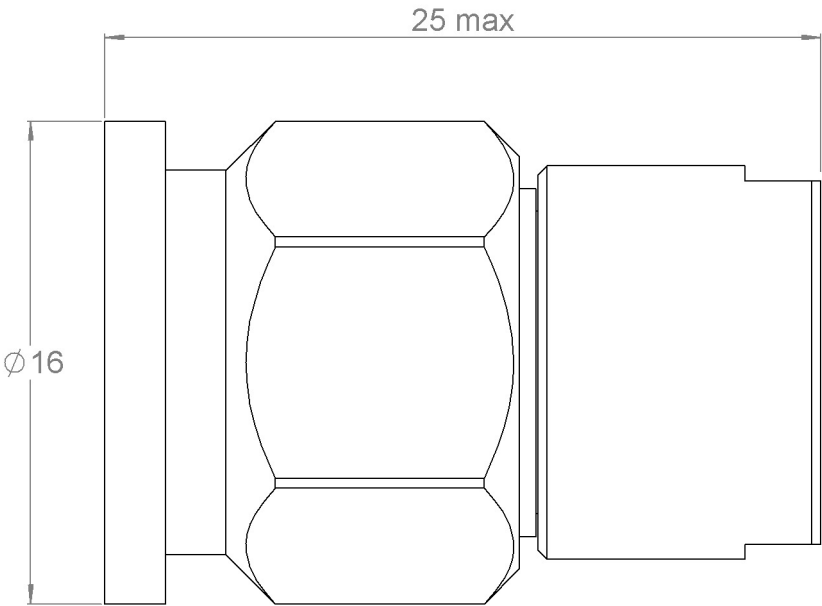
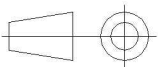

COMPONENTS	MATERIALS	PLATING ( $\mu\text{m}$ )
Body	<b>STAINLESS STEEL</b>	<b>PASSIVATED.</b>
Center contact	<b>BERYLLIUM COPPER</b>	<b>GOLD OVER NICKEL.</b>
Outer contact	<b>STAINLESS STEEL</b>	<b>PASSIVATED.</b>
Insulator	<b>PTFE</b>	
Gasket	<b>SILICONE</b>	
Substrate	<b>ALUMINA</b>	
Resistor	<b>THIN FILM</b>	
Others parts		

PAGE 2/2

ISSUE  
**19-01-26B**

SERIES  
**TERMINATION**

PART NUMBER **R404370000**

### ELECTRICAL CHARACTERISTICS

Frequency (GHz)	<b>DC - 4</b>	<b>4 - 8</b>	<b>8 - 12.4</b>	<b>12.4 - 18</b>
V.S.W.R ( $\leq$ )	<b>1.08</b>	<b>1.12</b>	<b>1.15</b>	<b>1.20</b>

Operating Frequency Range	<b>DC - 18</b>	GHz
Impedance	<b>50</b>	$\Omega$
DC Resistance	<b>50</b>	$\Omega \pm 5\%$
Peak power at 25°C (1 $\mu$ s, 1%)	<b>100</b>	W
Average power at 25°C	<b>2</b>	W (Free Air Cooled)
		W (Conduction Cooled)

### MECHANICAL CHARACTERISTICS

Connectors	<b>TNC</b>	<b>Male</b>	<b>MIL C 39012</b>
Weight ( $\pm 15\%$ )	<b>22,5207</b> g		

### ENVIRONMENTAL CHARACTERISTICS

Operating temperature range	<b>-55/+125</b>	°C
Storage temperature range	<b>-55/+125</b>	°C

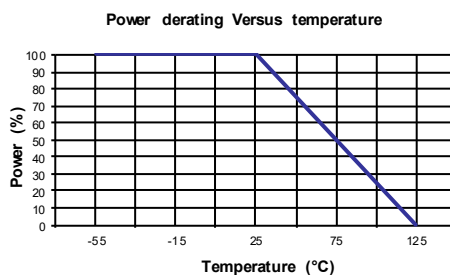

### SPECIFICATION

### OTHER CHARACTERISTICS

**Coupling torque 265 N.cm**