

PAGE 1/2	ISSUE 19-03-15B	SERIES R2CT	PART NUMBER R2CT107200
----------	-----------------	-------------	------------------------

-Dimensions in mm

+

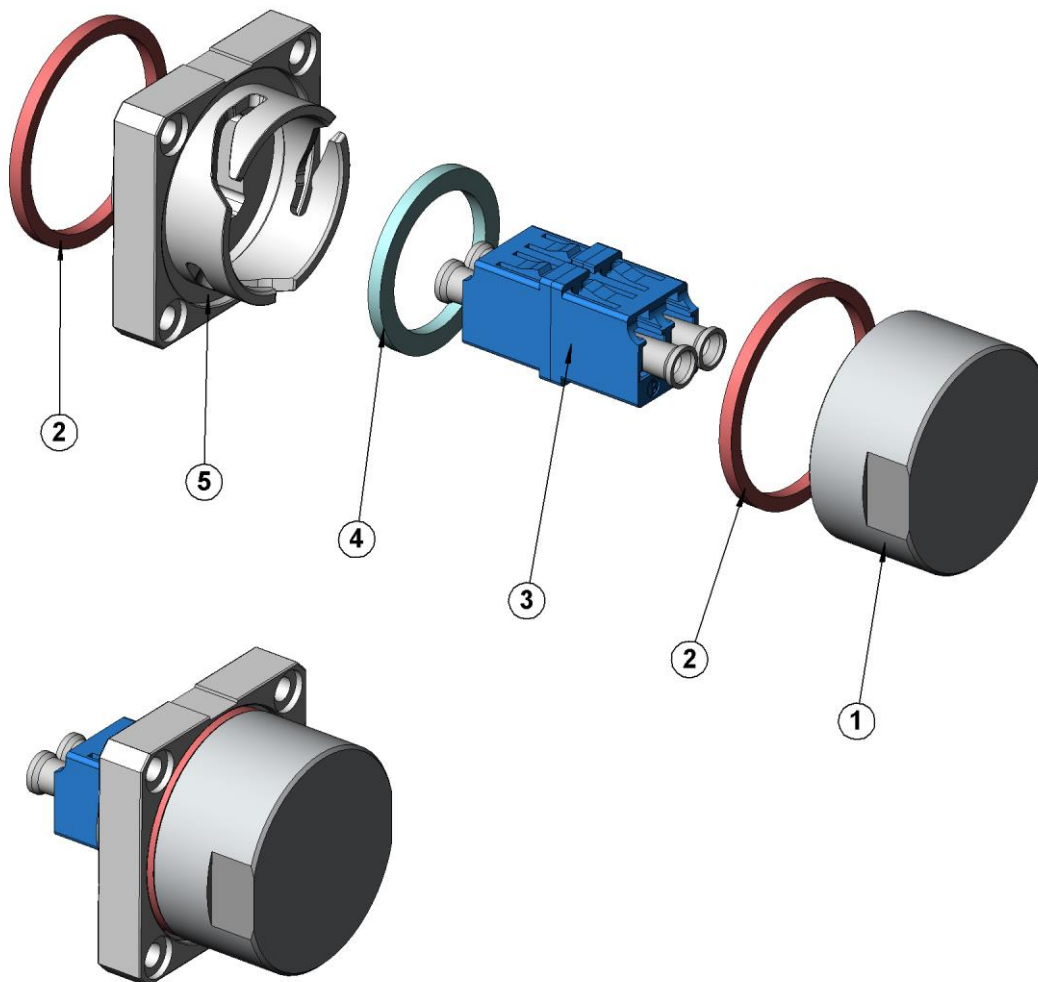

**DESCRIPTION**

REP	COMPONENT	MATERIALS	PLATING
1	PROTECTION CAP	ALUMINIUM	NONE
2	GASKET CONNECTION SEALING	SILICONE	
3	LC ADAPTOR (BLUE)	PEI	
4	GASKET	SILICONE	
5	RECEPTACLE BODY	BRASS	TIN NICKEL OVER COPPER

PAGE 2/2	ISSUE 19-03-15B	SERIES R2CT	PART NUMBER R2CT107200
----------	-----------------	-------------	------------------------

-Dimensions in mm

## GENERAL CHARACTERISTICS

<b>Mechanical</b> Mating endurance  <b>Optical:</b> Signal Alignment sleeve Other information	IEC 61300-2-2  - - -	<b>200 cycles</b>  <b>Singlemode</b> <b>Zirconia</b> <b>See technical data sheet F727.750.000</b>
<b>Environmental</b> Protection class Operating temperature	IEC 60529 IEC 61300-2-22	<b>IP65 mated</b> <b>-40°C to +85°C</b>
<b>Weight</b>	<b>77g</b>	
<b>Packaging</b>	<b>56 pieces in one cardboard box (volume = 5 L)</b>	

## PANEL CUT OUT

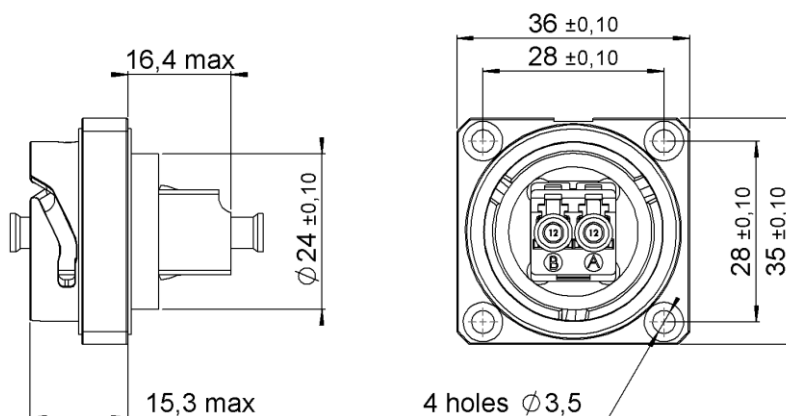

## PANEL CUT OUT

