

Series
NSX

SIZE 5 FRONT RELEASE, FRONT REMOVABLE
PC POST PIN COAX CONTACTS

Issue:
Dec. 15, 2008

Page
1/2

**RECOMMENDED
PC DRILL PATTERN**

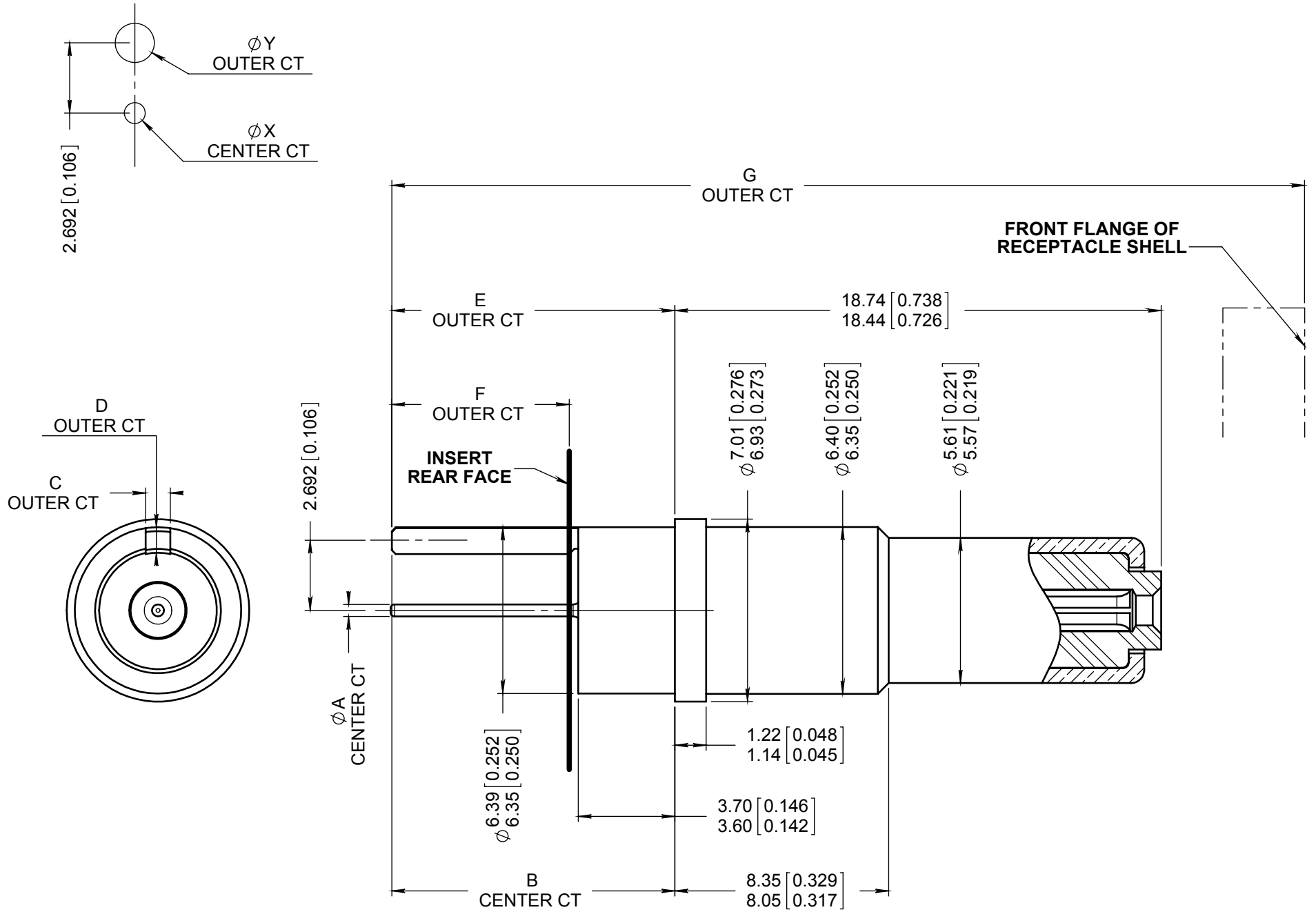

MATERIAL :

- OUTER CONTACT : BRASS PER QQ-B-626
- CENTER CONTACT : BERYLLIUM COPPER PER ASTM-B-196
- FERRULE : ANNEALED BRASS
- DIELECTRIC : PTFE PER ASTM-D-1710 OR EQUIVALENT

FINISH :

- CONTACT BODY : PLATING .00005 INCH OF GOLD PER SAE AMS-2422 OVER NICKEL PER SAE AMS-QQ-N-290

EXTRACTION TOOL : RADIAL 282 549 006 (MUST BE ORDER SEPARATELY)

DIMENSIONS : mm (inch are given for information only)

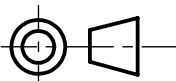

This information is given as an indication. In the continual goal to improve our products, we reserve the right to make any modifications judged necessary.

4112_9311

CREATION				
PEN:				
NOM: LEGENDRE T.				
DATE: Dec. 15, 2008				
APPR.: BROCHET L.	/	/	/	/
	Issue	Revisions	Name	Approved

4112_9311 This information is given as an indication. In the continual goal to improve our products, we reserve the right to make any modifications judged necessary.

	CTS P/N	CONTACT TERMINATION	ØA		B		C		D	
			BEFORE TINNING	AFTER TINNING	BEFORE TINNING	AFTER TINNING	BEFORE TINNING	AFTER TINNING	BEFORE TINNING	AFTER TINNING
NOT TINNED	620 133 009	YA	Ø0,51 (.021) Ø0,41 (.016)	NA	8,35 (.329)	NA	0,98 (.039) 0,92 (.036)	NA	0,98 (.039) 0,92 (.036)	NA
TIN LEADED		ZA		Ø0,63 MAX (.025)	7,95 (.312)	8,85 MAX (.349)		1,08 MAX (.043)		1,08 MAX (.043)
ROHS TINNED	620 133 509	RA		NA	11,15 (.439)	NA		NA		NA
NOT TINNED	620 133 006	Y		Ø0,63 MAX (.025)	10,75 (.423)	11,65 MAX (.459)		1,08 MAX (.043)		1,08 MAX (.043)
TIN LEADED	620 133 007	Z		NA	14,20 (.560)	NA		NA		NA
ROHS TINNED	620 133 506	R		Ø0,63 MAX (.025)	13,80 (.543)	14,70 MAX (.580)		1,08 MAX (.043)		1,08 MAX (.043)
NOT TINNED	620 133 003	YB		NA	17,50 (.689)	NA		NA		NA
TIN LEADED	620 133 001	ZB		Ø0,63 MAX (.025)	17,10 (.673)	18,00 MAX (.709)		1,08 MAX (.043)		1,08 MAX (.043)
ROHS TINNED	620 133 503	RB		NA				NA		NA
NOT TINNED	620 133 010	YC		Ø0,63 MAX (.025)				1,08 MAX (.043)		1,08 MAX (.043)
TIN LEADED		ZC								
ROHS TINNED	620 133 510	RC								
			E	F EXTENTION / INSERT REAR FACE		G EXTENTION / FRONT FLANGE OF SHELL		ØX	ØY	
		CONTACT TERMINATION	BEFORE TINNING	AFTER TINNING	BEFORE TINNING	AFTER TINNING	BEFORE TINNING	AFTER TINNING		
NOT TINNED	620 133 009	YA	8,05 (.317)	NA	4,60 (.181)	NA	35,20 (1.385)	NA	Ø0,60 MN (.023) Ø1,50 MN (.059)	
TIN LEADED		ZA	7,95 (.312)	8,55 MAX (.337)	3,81 (.150)	5,10 MAX (.201)	33,80 (1.330)	35,70 MAX (1.405)	Ø0,75 MN (.029) Ø1,80 MN (.070)	
ROHS TINNED	620 133 509	RA	10,85 (.428)	NA	7,20 (.283)	NA	37,80 (1.488)	NA	Ø0,60 MN (.023) Ø1,50 MN (.059)	
NOT TINNED	620 133 006	Y	10,75 (.423)	11,35 MAX (.447)	6,40 (.252)	7,70 MAX (.303)	36,40 (1.433)	38,30 MAX (1.508)	Ø0,75 MN (.029) Ø1,80 MN (.070)	
TIN LEADED	620 133 007	Z	13,90 (.548)	NA	10,30 (.406)	NA	41,00 (1.614)	NA	Ø0,60 MN (.023) Ø1,50 MN (.059)	
ROHS TINNED	620 133 506	R	13,80 (.543)	14,40 MAX (.567)	9,50 (.374)	10,80 MAX (.426)	39,60 (1.559)	41,50 MAX (1.634)	Ø0,75 MN (.029) Ø1,80 MN (.070)	
NOT TINNED	620 133 003	YB	17,20 (.678)	NA	13,60 (.535)	NA	44,20 (1.740)	NA	Ø0,60 MN (.023) Ø1,50 MN (.059)	
TIN LEADED	620 133 001	ZB	17,10 (.673)	17,70 MAX (.697)	12,80 (.504)	14,10 MAX (.555)	42,80 (1.685)	44,70 MAX (1.760)	Ø0,75 MN (.029) Ø1,80 MN (.070)	
ROHS TINNED	620 133 503	RB								
NOT TINNED	620 133 010	YC								
TIN LEADED		ZC								
ROHS TINNED	620 133 510	RC								