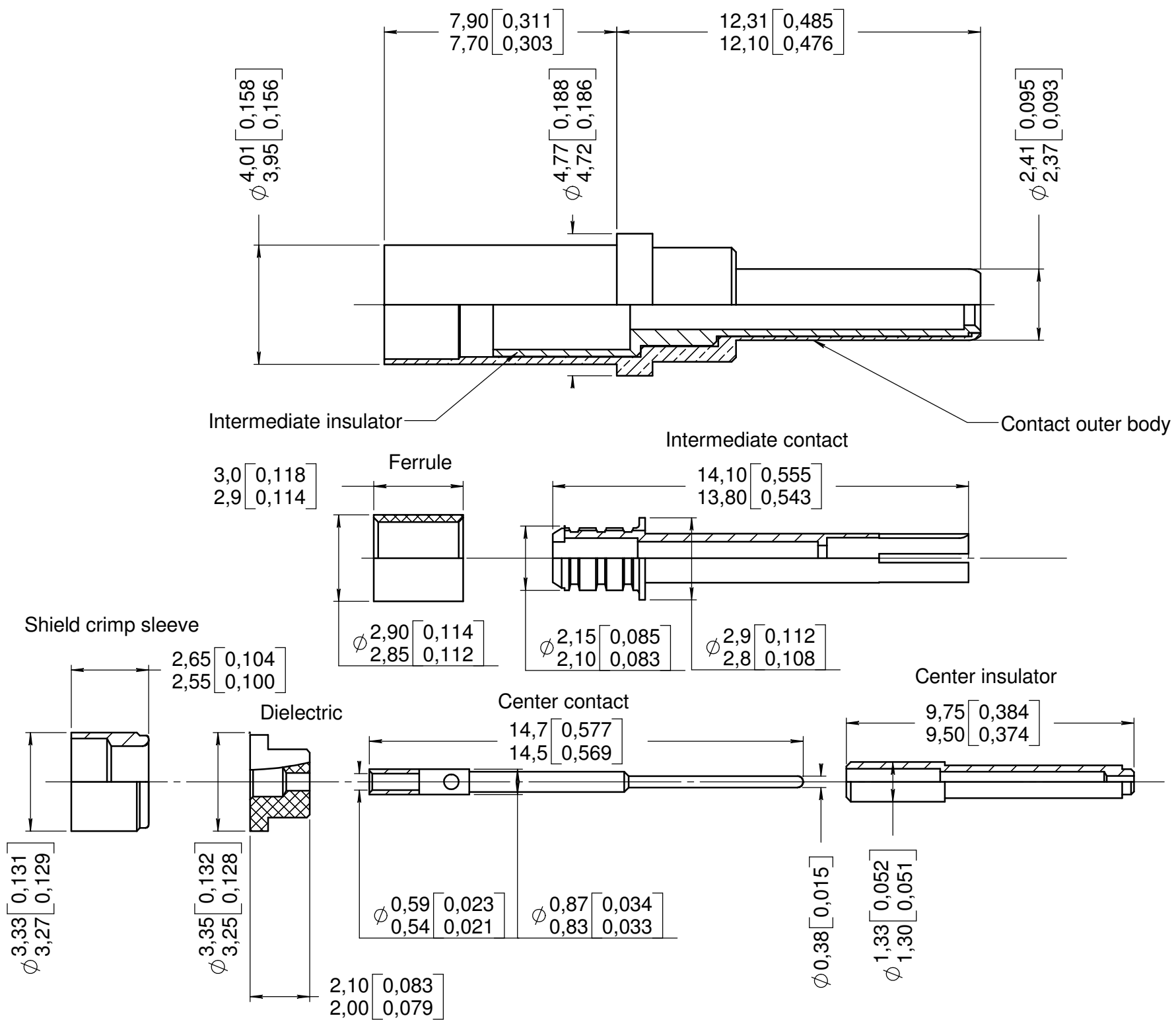

**Series**  
 EPX

**CONCENTRIC SIZE 12 TWINAX PIN CONTACT**  
 FOR ECS 0700 CABLE

**Issue:**  
 Apr 14, 2005

**Page**  
 1/1

**Material :**

- Outer body contact, intermediate contact and center contact : beryllium copper per ASTM-B-196.
- Shield crimp sleeve and ferrule : Copper alloy per EN-12164.
- Dielectric and insulators: PTFE per ASTM-D-1710 or equivalent.

**Finish :**

- All metallic parts : Plating 0.00005 inch of gold per SAE AMS-2422 over nickel per SAE AMS QQ-N-290.

**WIRING INSTRUCTIONS : SEE RP54889**

DIMENSIONS : mm (inch) -

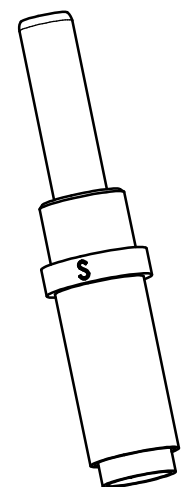
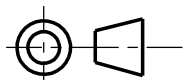

This information is given as an indication. In the continual goal to improve our products, we reserve the right to make any modifications judged necessary.

4112\_9311

CREATION	04.14.05	"S" added on the outer body.	M.Pessard	L.Garcia
	04.01.05	Dimensions and material standards added	LeGloahec	Pessard M.
PEN: M990011392A	08.26.04	Flange added on the intermediate contact.	M.Pessard	L.Garcia
	07.22.04	Designation: twinax was triax.	L.Garcia	C.Lahoreau
NOM: B. VAN DEN	11.26.03	redrawn and updated	F.Legave	L.Garcia
DATE: 08/28/00	03.12.02	617190010 was 617190001	L.Garcia	G.Motteau
	08-28-00	617190001 was RP 54599	B.Van Den	A.Baldyrou
APPR.:	Issue	Revisions	Name	Approved

617190010EN