

Series
EPX

SIZE 15 COAXIAL CONTACTS FOR SEMIRIGID CABLES .047

Issue:
08/17/2011

Page
1/1

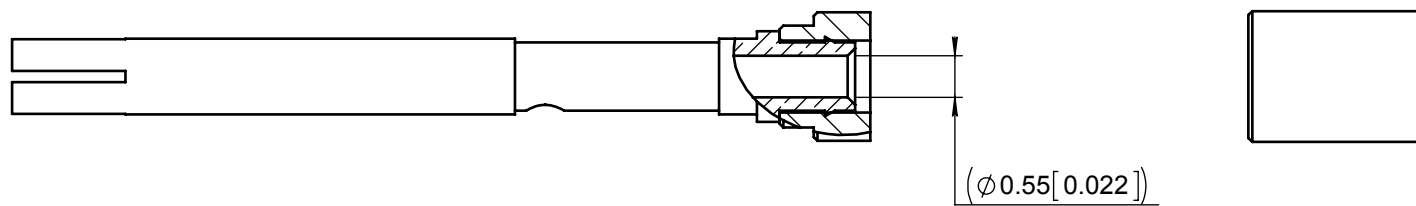
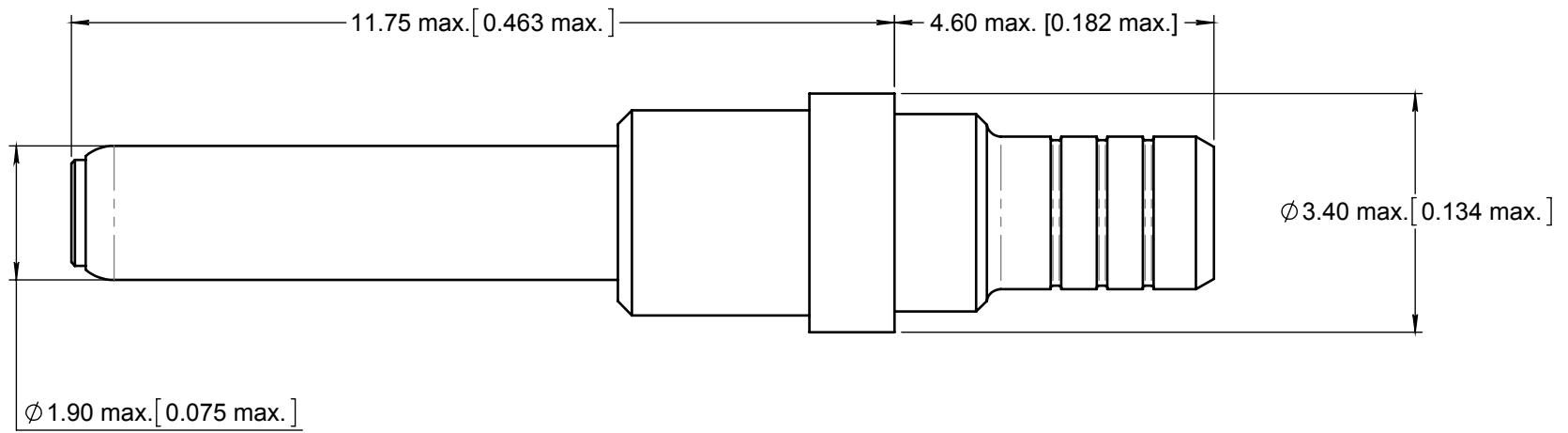

MATERIAL AND FINISH:

CONTACT BODY, CENTRAL CONTACT, FERRULE: COPPER ALLOY; GOLD OVER NICKEL PLATED

INSULATOR: PTFE OR EQUIVALENT

Refer to RP6383 for wiring instructions.

DIMENSIONS : mm (inch are given for information only)

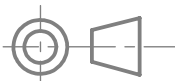

Confidential information not to be disclosed to third parties without Radiall approval. This information is given as an indication. In the continual goal to improve our products, we reserve the right to make any modifications judged necessary.

4112_9311

CREATION				
PEN: 89 056				
NOM:				
DATE: 12/26/1989				
APPR.:	08/17/11	Translation in english + dim in max	LEBOCQ	LE GLOAHEC
	Issue	Revisions	Name	Approved