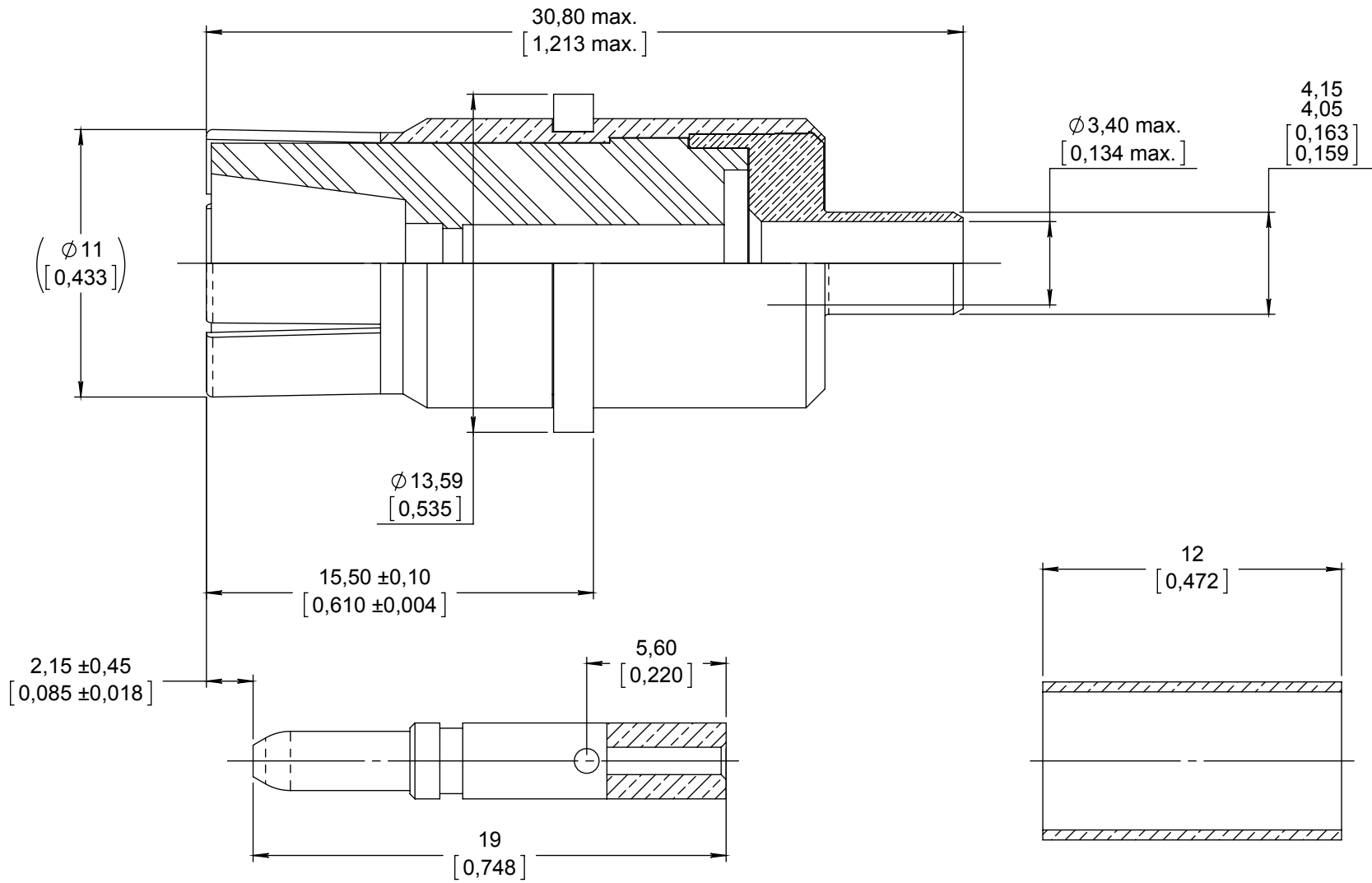

**Series
DSX**
**SIZE 1 PIN COAXIAL CONTACT
FOR RG142 CABLE**
**Issue:
Nov. 26, 2015**
**Page
1/3**

MATERIAL :

OUTER BODY, CENTER CONTACT AND : BERYLIUM COPPER PER ASTM-B-196
 FERULE : COPPER ALLOY
 INSULATOR : PTFE PER ASTM-B-1710 OR EQUIVALENT

FINISH :

ALL METALIC PARTS : .00005 INCH OF GOLD PER MIL-DTL-45204 OVER NICKEL PER AMS 2403

NOTE :

IMPEDANCE : 50 OHMS
 DIELECTRIC WITHSTANDING VOLTAGE : 1000 V
 VSWR : 1.3 FROM 10 MHz TO 5 GHz

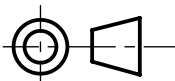
DIMENSIONS : mm (inch are given for information only)

Estimated weight : 12 g

This document contains proprietary information and such information shall not be disclosed to any third party for any purpose whatsoever or used for manufacturing purposes without prior written agreement from RADIALL. This information is given as an indication. In the continual goal to improve our products, we reserve the right to make any modifications judged necessary.

4112_9311

CREATION				
PEN: 20154208-208				
NOM: MOUTAULT W.				
DATE: Nov. 06, 2015	Nov. 26, 15	Add mounting instruction page 3	Moutault	Legendre
APPR.: LEGENDRE T.	Nov. 09, 15	Add crimping instruction page 2	Moutault	Legendre
	Issue	Revisions	Name	Approved

CRIMPING INSTRUCTION

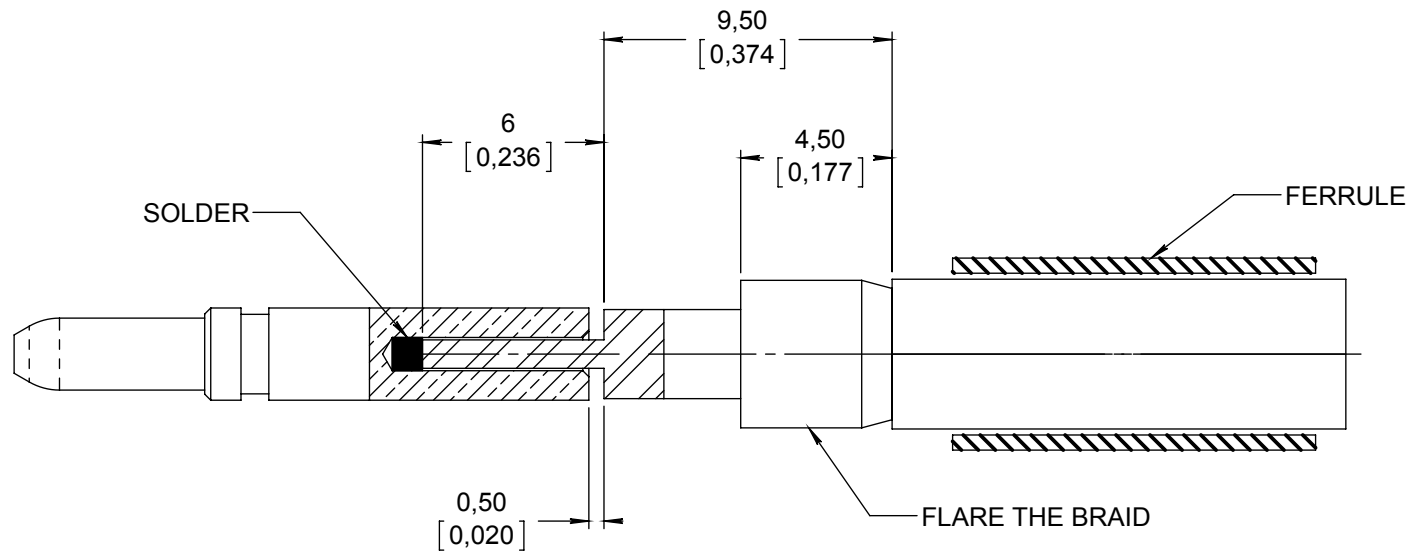

STEP 1 :

- STRIP CABLE TO DIMENSIONS SHOWN
- SLIDE FERRULE OVER CABLE
- SLIDE CENTER CONTACT BARREL OVER CABLE CONDUCTOR AND SOLDER

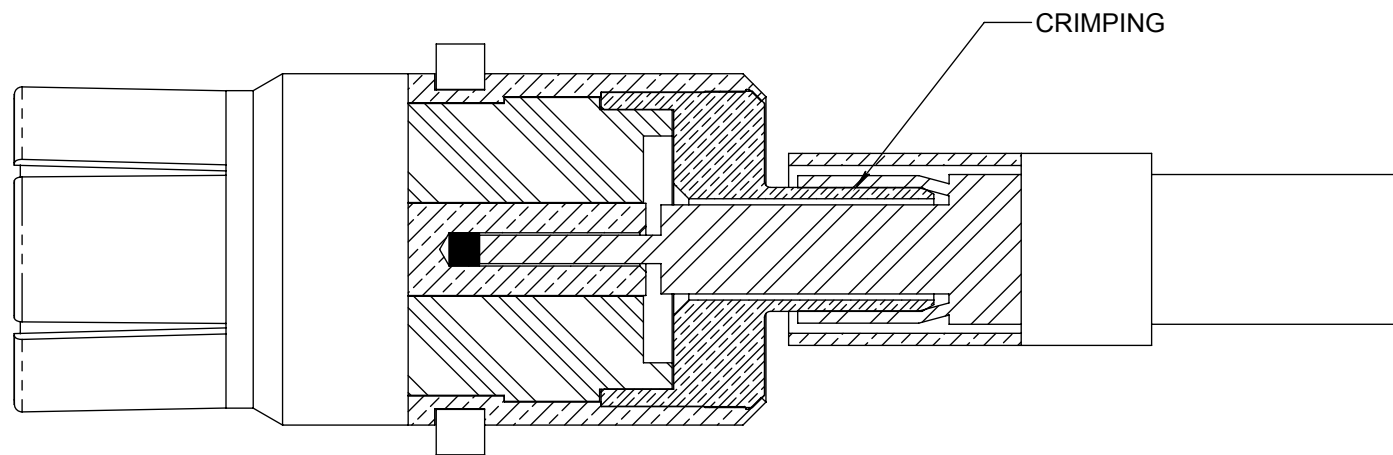

STEP 2 :

- INSERT CENTER CONTACT INTO THE OUTER CONTACT BODY
- PLACE SHIELDS OVER KNURLED PART OF OUTER CONTACT BODY
- SLIDE FERRULE OVER SHIELDS UNTIL TO DIMENSIONS SHOWN
- CRIMP FERRULE

TOOL :

- OUTER CONTACT : CRIMPING TOOL : M22520/5_01 (RADIAL 282293)
DIE : M22520/5_05 (RADIAL 282246) Hex A

This document contains proprietary information and such information shall not be disclosed to any third party for any purpose whatsoever or used for manufacturing purposes without prior written agreement from RADIAL. This information is given as an indication. In the continual goal to improve our products, we reserve the right to make any modifications judged necessary.

4112_9311

MOUNTING INSTRUCTION

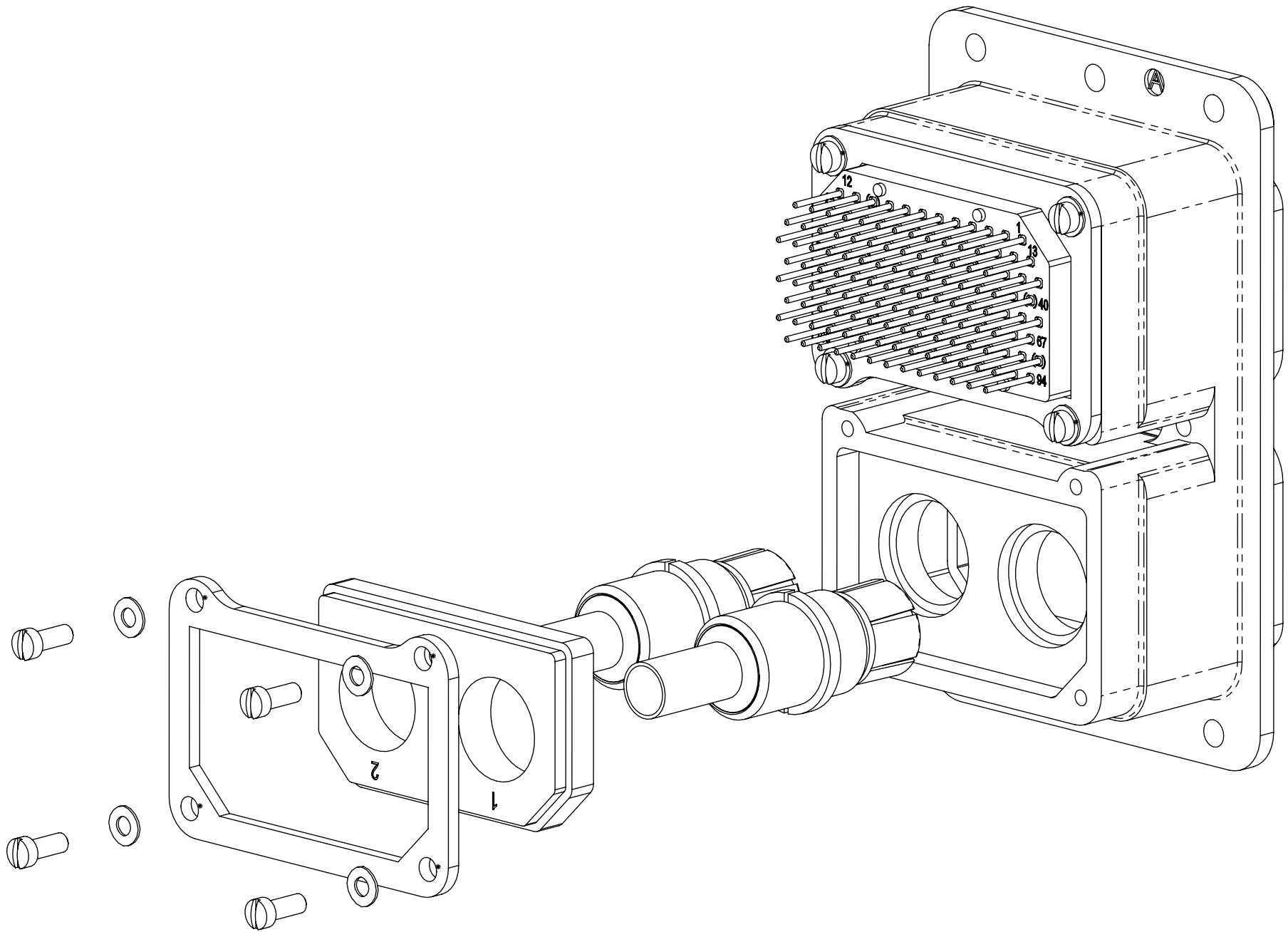

STEP 1

INSERT ONLY THE FRONT METALLIC MC2 PLATE IN THE CONNECTOR SHELL.

SLIDE THE INSERT RETENTION PLATE, AND THE REAR METALLIC MC2 PLATE ON THE 2 CABLES BEFORE CRIMPING THE COAXIAL CONTACTS

CHECK THE CORRECT THE ORIENTATION OF THE 2 METALLIC MC2 PLATES

CRIMP THE CABLE ON THE COAXIAL CONTACTS (SEE CRIMPING INSTRUCTION PAGE 2/3)

INSTALL ALL THE CABLE ASSEMBLY IN THE CONNECTOR, SLIDE DOWN THE REAR METALLIC MC2 PLATE AND THE INSERT RETENTION PLATE

LASTLY, FIX THE INSERT RETENTION PLATE WITH 4 SCREWS TORQUED AT 0.252 / 0.280 N.m

This document contains proprietary information and such information shall not be disclosed to any third party for any purpose whatsoever or used for manufacturing purposes without prior written agreement from RADIALL. This information is given as an indication. In the continual goal to improve our products, we reserve the right to make any modifications judged necessary.