

**PLUG MML H2.0-H2.5-PLUG SMA ADAPTER**

**R302.303.001**

Série : **ADAPTER**

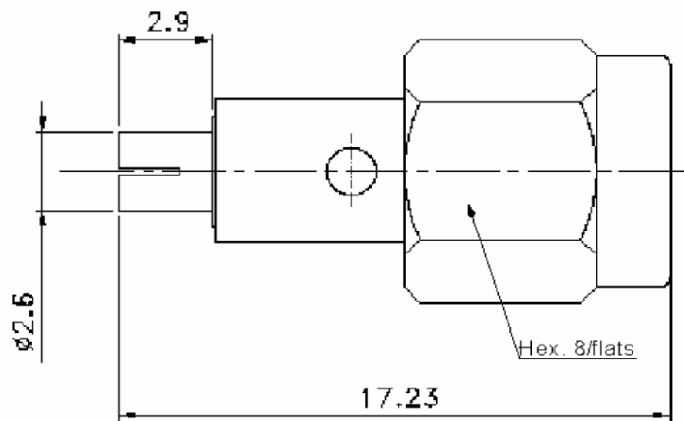

All dimensions are in mm.

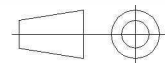

COMPONENTS	MATERIALS	PLATING ( $\mu\text{m}$ )
<b>BODY</b>	<b>BRASS,BERYLLIUM COPPER</b>	<b>GOLD</b>
<b>CENTER CONTACT</b>	<b>BRASS</b>	<b>GOLD</b>
<b>OUTER CONTACT</b>		
<b>INSULATOR</b>	<b>PTFE</b>	
<b>GASKET</b>		
<b>OTHERS PARTS</b>	<b>STAINLESS STEEL</b>	
-	-	-
-	-	-

**Issue : 1020 A**

In the effort to improve our products, we reserve the rights to make changes judged to be necessary.



**PLUG MML H2.0-H2.5-PLUG SMA ADAPTER**

**R302.303.001**

Série : **ADAPTER**

**PACKAGING**

**SPECIFICATION**

Standard	Unit	Other
<b>1</b>	-	<b>Contact us</b>

**ELECTRICAL CHARACTERISTICS**

**ENVIRONMENTAL**

Impedance	<b>50</b> Ω
Frequency	<b>0-6</b> GHz
VSWR	<b>1.2 + 0,0000</b> x F(GHz) Maxi
Insertion loss	<b>0.1</b> √F(GHz) dB Maxi
RF leakage	- ( <b>NA</b> - F(GHz)) dB Maxi
Voltage rating	<b>200</b> Veff Maxi
Dielectric withstanding voltage	<b>200</b> Veff mini
Insulation resistance	<b>500</b> MΩ mini

Operating	<b>-40/+90</b> ° C
Hermetic seal	<b>NA</b> Atm.cm3/s
Panel leakage	<b>NA</b>

**MECHANICAL CHARACTERISTICS**

**OTHER CHARACTERISTICS**

Center contact retention		
Axial force – Mating end	<b>NA</b>	<b>N mini</b>
Axial force – Opposite end	<b>NA</b>	<b>N mini</b>
Torque	<b>NA</b>	<b>N.cm mini</b>
Recommended torque		
Mating	<b>MML</b>	<b>0</b> N.cm
	<b>SMA</b>	<b>100</b> N.cm
		<b>0</b> N.cm
Panel nut	<b>NA</b>	<b>N.cm</b>
Mating life	<b>100</b>	<b>Cycles mini</b>
Weight	<b>2,6000</b>	<b>g</b>

Issue : **1020 A**

In the effort to improve our products, we reserve the rights to make changes judged to be necessary.

