

PACKAGING 10

REMOVABLE MALE CONTACT

SERIES: ACC COA 1 / 1

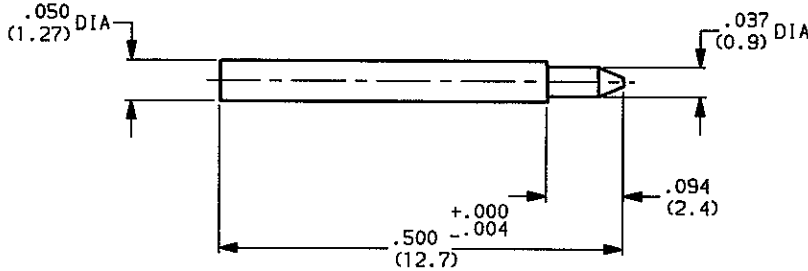

R. I.M.C.  
G.M.B.H.

6

WEIGHT oz ( g )

cables:

CHARACTERISTICS

NOMINAL IMPEDANCE	-	Ω
FREQUENCY RANGE	-	GHz
TEMPERATURE RATING	-65/+165	°C
VSWR	-	Max
RF INSERTION LOSS	-	dB Max
VOLTAGE RATING	-	V <sub>rms</sub>
DIELECTRIC WITHSTANDING VOLTAGE	-	V <sub>rms</sub>
INSULATION RESISTANCE	-	MΩ
HERMETIC SEAL	NA	cc/s cm <sup>3</sup> /s
LEAKAGE (pressurized only)	-	psi kg/cm <sup>2</sup>
-	-	-
-	-	-

STANDARDISATION

CABLE RETENTION

NA Lb Min  
N Min

CENTER CONTACT RETENTION

Axial force - mating end

NA Lb Min  
N Min

Axial force - opposite end

NA Lb Min  
N Min

Torque (Min)

NA inch.oz  
cm.N

RECOMMENDED TORQUES

Mating

NA inch. Lb

Panel nut

NA inch. Lb

Clamp nut

NA inch. Lb  
cm. N

CONSTRUCTION

CONNECTOR PARTS	MATERIALS	FINISH
BODY	-	-
OUTER CONTACT	-	-
CENTER CONTACT	Beryllium copper	Gold over nickel
INSULATORS	-	-
-	-	-
-	-	-
-	-	-
-	-	-
-	-	-

ISSUE	REVISION No	DESCRIPTION	BY	DATE
.	.	.	.	.
.	.	.	.	.
.	.	.	.	.
.	.	.	.	.

Initiated on 28-FEB-90

The information given here is subject to change without notice. Design changes may be in order to improve the product.



Superseded on