

U LINK FEMALE_FEMALE

R214.797.723

PITCH 9 MM

Series : UHDC 43

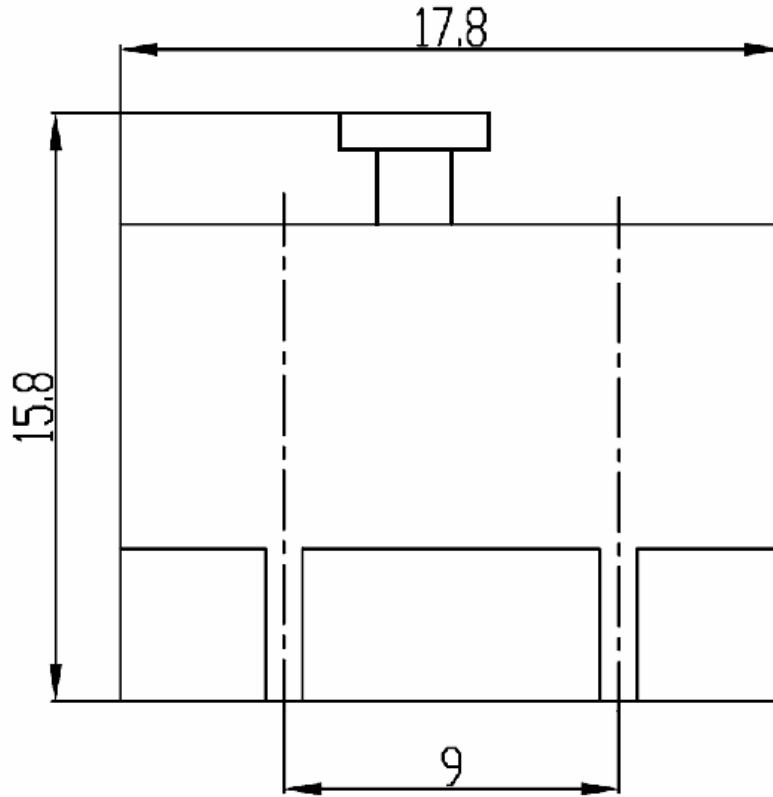

All dimensions are in mm.

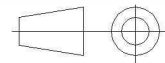

COMPONENTS	MATERIALS	PLATING (µm)
BODY	ZAMAK	NICKEL
CENTER CONTACT	BRONZE	GOLD
OUTER CONTACT	BRASS	GOLD
INSULATOR	PTFE	
GASKET	-	
OTHERS PARTS	-	
-	-	-
-	-	-

Issue : 1132 D

In the effort to improve our products, we reserve the right to make changes judged to be necessary.



U LINK FEMALE_FEMALE

R214.797.723

PITCH 9 MM

Series : UHDC 43

PACKAGING

SPECIFICATION

Standard	Unit	Other
50	-	Contact us

ELECTRICAL CHARACTERISTICS

ENVIRONMENTAL

Impedance	75	Ω
Frequency	0-3	GHz
VSWR	NA + 0,0000	x F(GHz) Maxi
Insertion loss	NA	$\sqrt{F(GHz)}$ dB Maxi
RF leakage	NA - (NA - F(GHz)) dB Maxi
Voltage rating	500	Veff Maxi
Dielectric withstanding voltage	1500	Veff mini
Insulation resistance	5000	M Ω mini

Operating temperature	-40/+100	$^{\circ}$ C
Hermetic seal	-	Atm.cm3/s
Panel leakage	-	

OTHER CHARACTERISTICS

Assembly instruction **NA**

Others :
-

MECHANICAL CHARACTERISTICS

Center contact retention		
Axial force – Mating end	22	N mini
Axial force – Opposite end	-	N mini
Torque	-	N.cm mini
Recommended torque		
Mating	-	N.cm
Panel nut	-	N.cm
Mating life	0	Cycles mini
Weight	6,8000	g

Issue : 1132 D

In the effort to improve our products, we reserve the right to make changes judged to be necessary.

