

PAGE 1/2	ISSUE 1428A	SERIES <b>ADAPT</b>	PART NUMBER <b>R191.956.020</b>
----------	-------------	---------------------	---------------------------------

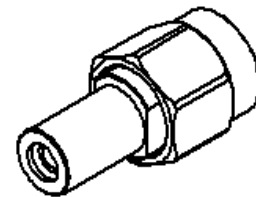

All dimensions are in mm.

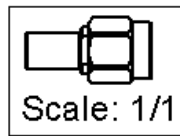
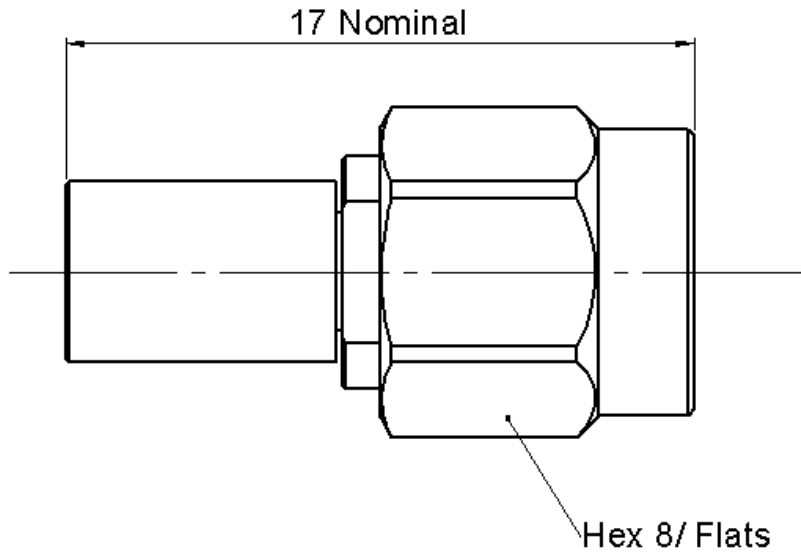
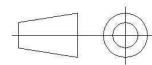

COMPONENTS	MATERIALS	PLATING (µm)
Body	<b>BRASS/ BERYLLIUM COPPER</b>	<b>NPGR / GOLD OVER NICKEL</b>
Center contact	<b>BERYLLIUM COPPER</b>	<b>GOLD OVER NICKEL</b>
Outer contact	-	-
Insulator	<b>PEEK</b>	-
Gasket	<b>SILICONE RUBBER</b>	-
Others parts	<b>STAINLESS STEEL</b>	<b>PASSIVATED</b>
-	-	-
-	-	-

PAGE <b>2/2</b>	ISSUE 1428A	SERIES <b>ADAPT</b>	PART NUMBER <b>R191.956.020</b>
-----------------	-------------	---------------------	---------------------------------

**PACKAGING**

Standard	Unit	Other
<b>1</b>	<b>Contact us</b>	<b>Contact us</b>

**ELECTRICAL CHARACTERISTICS**

Impedance	<b>50</b>	Ω
Frequency	<b>0-40</b>	GHz
VSWR	* <b>0.0000</b>	x F(GHz) Maxi
Insertion loss	**	√F(GHz) dB Maxi
RF leakage	-(	- F(GHz)) dB Maxi
Voltage rating	<b>335</b>	Veff Maxi
Dielectric withstanding voltage	<b>500</b>	Veff mini
Insulation resistance	<b>5000</b>	MΩ mini

**ENVIRONMENTAL**

Operating	<b>-40/+105</b>	°C
Hermetic seal	<b>NA</b>	Atm.cm3/s
Panel leakage	<b>NA</b>	

**MECHANICAL CHARACTERISTICS**

Center contact retention		
Axial force – Mating End	<b>6.7</b>	N mini
Axial force – Opposite end	<b>6.7</b>	N mini
Torque	<b>NA</b>	N.cm mini

**SPECIFICATION**

Recommended torque		
Mating	<b>NA</b>	N.cm
	<b>0</b>	N.cm
	<b>0</b>	N.cm
Panel nut	<b>NA</b>	N.cm

**OTHER CHARACTERISTICS**

- **0-22GHz / 0-40GHz:**
- \* **1.18max / 1.6max**
- \*\* **0.15dB max / 0.35dB max**

Mating life	<b>500</b>	Cycles mini
Weight	<b>3.46</b>	g