

STRAIGHT CABLE JACK CLAMP TYPE CABLE 3/8" HELICAL	R185.217.200 SERIES 7-16
--	---

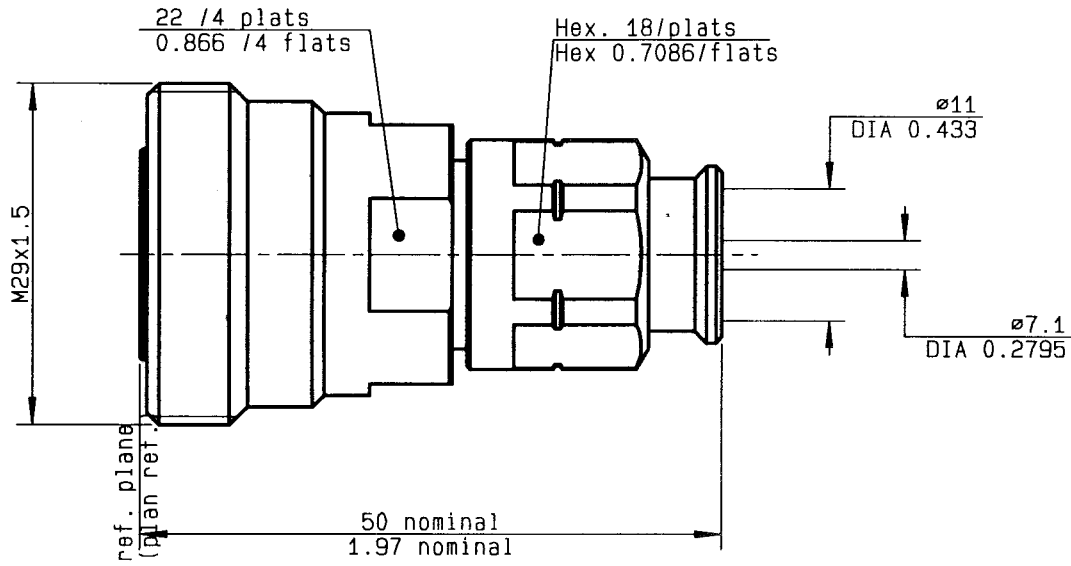

NOMINAL IMPEDANCE	50 Ω	CABLES : FSJ2-50-3/8" HELIAX
FREQUENCY RANGE	0-7.5 GHz	HCF 3/8" Cu2Y 1Cu
TEMPERATURE RATING	-55/+155 °C	HCF 3/8" CuH
V.S.W.R	1.30 + 0 x F(GHz)Maxi	
RF INSERTION LOSS	0.005 √F(GHz) dB Maxi	
VOLTAGE RATING	1400 Veff Maxi	
DIELECTRIC WITHSTANDING VOLTAGE	2700 Veff Mini	
INSULATION RESISTANCE	10000 MΩMini	OTHERS CHARACTERISTICS
HERMETIC SEAL	NA Atm.cm ³ /s	ROS : 1.10 a 3 GHz
LEAKAGE (pressurized only)	IP 67	CABLE RETENTION
MCHANICAL DURABILITY	500 Cycles	250 N Mini
WEIGHT	98.8 gr	CENTER CONTACT RETENTION
SPECIFICATION		Axial force - mating end 200 N Mini
		Axial force - opposite end 100 N Mini
		Torque 2 cm.N Mini
		RECOMMENDED TORQUES
		Mating NA cm.N
		Panel nut NA cm.N
		Clamp nut 950 cm.N

CONNECTOR PARTS:	MATERIALS	FINISH (all values are given in micrometers)
BODY	BRASS	BBR 0.5 OVER SILVER 3
OUTER CONTACT	BRASS	SILVER 5 OVER COPPER 0.5
CENTER CONTACT	BERYLLIUM COPPER	SILVER 5 OVER COPPER 0.5
INSULATOR	PTFE	-
GASKET	SILICONE RUBBER	-
OTHERS PIECES	BRASS	BBR 2

ISSUE	CREATION DATE	FILE PART-NUMBER	
9945A00	05/05/1999	EPC96-02	RADIALL®

The information given here is subject to change without notice. Design changes may be in order to improve the product.

Connect to the future



RADIALL®

R185.217.200

ISSUE 9945A00 SERIES 7-16

HEATSHRINK SLEEVE

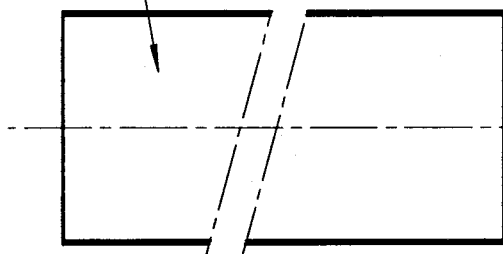

BRAID CLAMP NUT

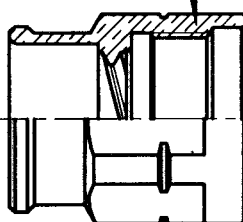

GASKET

BODY

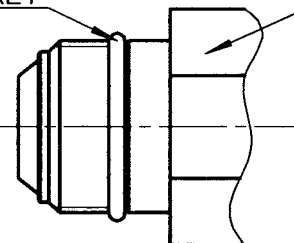

- ①
- Strip the cable.
Stripping tool R282.010.040
 - Do not damage the outer conductor.
 - Deburr cable inner conductor.

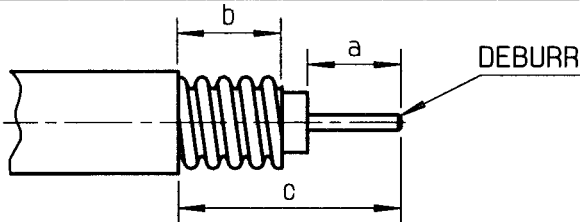

Stripping	a	b	c	d	e
inch	0.217	0.197	0.453	0	0
mm	5.5	5	11.5		

- ②
- Slide the heatshrink sleeve onto the cable.
 - Screw manually the braided clamp nut onto cable outer conductor until stop.

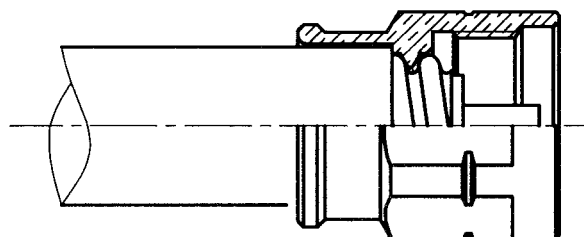

- ③
- Screw the connector onto the assembly.
- WARNING : Screw the connector on the braided clamp nut turning left (lefthand thread) so that the copper outer conductor is being squeezed.

Torque wrench R282.303.220
Recommended coupling torque: 84.07 in.lb
950 Ncm

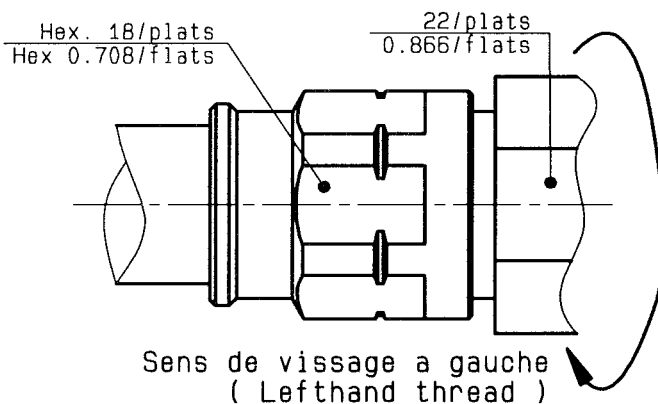

- ④
- Shrink the heatshrink sleeve.

Shrink the heatshrink sleeve

