

**STRAIGHT SQUARE FLANGE JACK**

**CRIMP TYPE - CABLE 3.85/50S**

**R161.254.025**

Series : N

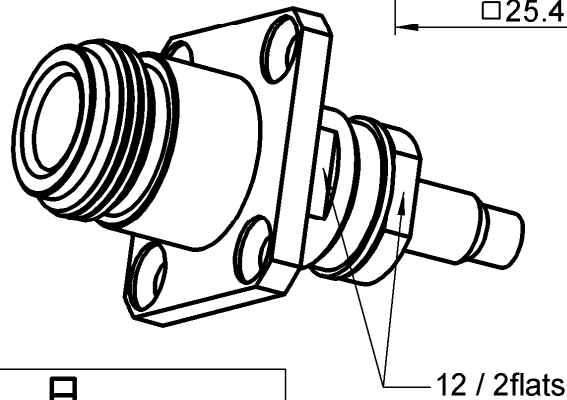
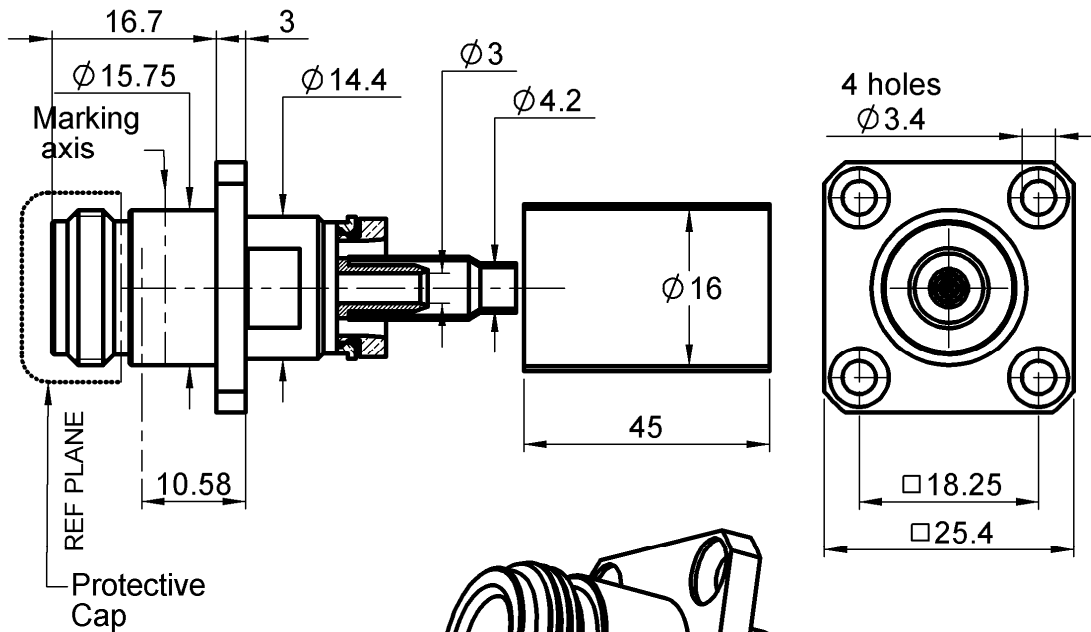

**PANEL CUT OUT**

	mm	
	Maxi	mini
A (R. Mount)	16.3	16.1
A (F. Mount)	14.8	14.6
B	3.3	3.2
C	18.35	18.15

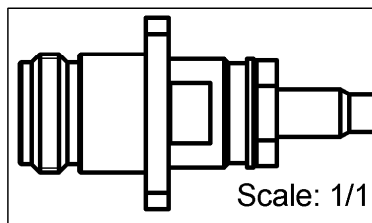

All dimensions are in mm.

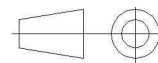

COMPONENTS	MATERIALS	PLATING (µm)
BODY	BRASS	NICKEL 2
CENTER CONTACT	BERYLLIUM COPPER	GOLD 1.3 OVER NICKEL2
OUTER CONTACT	-	-
INSULATOR	PTFE	-
GASKET	-	-
OTHERS PARTS	BRASS	NICKEL 2
-	-	-
-	-	-

Issue : 1313 A

In the effort to improve our products, we reserve the right to make changes judged to be necessary.



**STRAIGHT SQUARE FLANGE JACK**

**R161.254.025**

**CRIMP TYPE - CABLE 3.85/50S**

Series : N

**PACKAGING**

Standard	Unit	Other
<b>50</b>	<b>OPTION W</b>	<b>Contact us</b>

**SPECIFICATION**

**ELECTRICAL CHARACTERISTICS**

Impedance	<b>50</b>	$\Omega$
Frequency	<b>0-11</b>	GHz
VSWR	<b>1.2* + 0,0000</b>	x F(GHz) Maxi
Insertion loss	<b>0.1</b>	$\sqrt{F}$ (GHz) dB Maxi
RF leakage	- ( <b>57</b> )	- F(GHz)) dB Maxi
Voltage rating	<b>850</b>	Veff Maxi
Dielectric withstanding voltage	<b>1000</b>	Veff mini
Insulation resistance	<b>5000</b>	M $\Omega$ mini

**CABLE ASSEMBLY**

Stripping	a	b	c	d	e	f
mm	9,00	9,00	23,0	0,00	0,00	0,00

Assembly instruction :

Recommended cable(s)  
ASN-EO691-WM

Characteristics indicated on this data sheet are those that can be achieved with the highest performance cable. Intrinsic limitations of the cable may diminish the performance of the assembly

Cable retention

- pull off	<b>140</b>	N mini
- torque	<b>NA</b>	N.cm

**MECHANICAL CHARACTERISTICS**

Center contact retention		
Axial force – Mating end	<b>27</b>	N mini
Axial force – Opposite end	<b>27</b>	N mini
Torque	<b>NA</b>	N.cm mini

Recommended torque		
Mating	<b>NA</b>	N.cm
Panel nut	<b>NA</b>	N.cm
Clamp nut	<b>370</b>	N.cm
A/F clamp nut	<b>12,0000</b>	mm

Mating life	<b>500</b>	Cycles mini
Weight	<b>11,3460</b>	g

**TOOLING**

Part Number	Description	Hexagon
282.291	CRIMPING TOOL M22520/1-01	Position 7
282.997	POSITIONER FOR TOOL 282.291(M22520/1-13)	Red Tourette
R282.293.000	CRIMPING TOOL M22520/5-01	
R282.223.000	CRIMPING TOOL	Hex 5.41
R282.246.000	CRIMPING DIES M22520/5-05	Hex 5.41

**Mil TOOLING REF EQUIVALENT :**

M22520/1-01 = 282.991  
M22520/1-13 = 282.997  
M22520/5-05 = R282.246.000

**ENVIRONMENTAL**

Operating temperature	<b>-65/+165</b>	$^{\circ}$ C
Hermetic seal	<b>NA</b>	Atm.cm3/s
Panel leakage	<b>NA</b>	

**OTHER CHARACTERISTICS**

\*DC-3 GHz

Issue : 1313 A

In the effort to improve our products, we reserve the right to make changes judged to be necessary.



**STRAIGHT SQUARE FLANGE JACK**

**R161.254.025**

**CRIMP TYPE - CABLE 3.85/50S**

Series : N

**COMPONENTS**

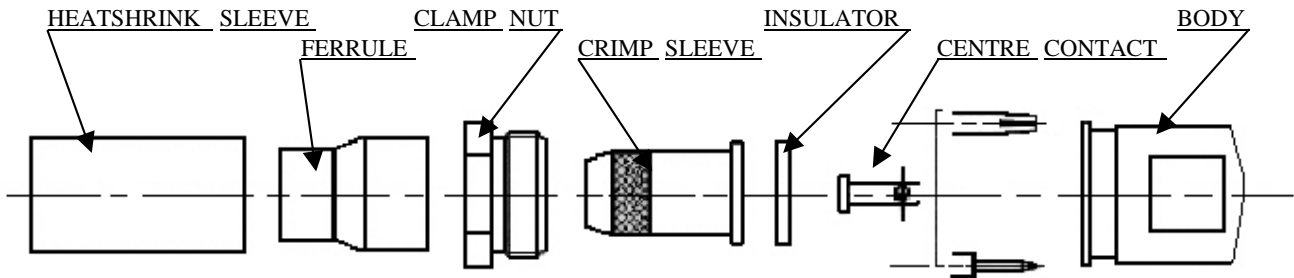

1

Slide onto the cable the heatshrink and the ferrule.  
Strip the cable and cut the foil under the braid .

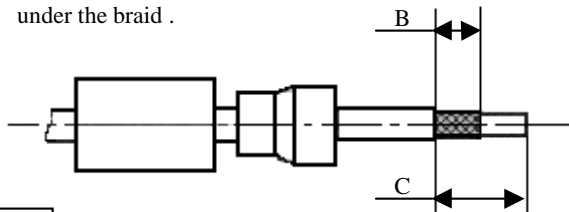

2

Slide the clamp nut onto the crimp sleeve.  
Slide sub-a ssembly under the braid.  
Slide ferrule over the braid against clamp nut.(In direction F)  
Crimp the ferrule with crimping tool + dies

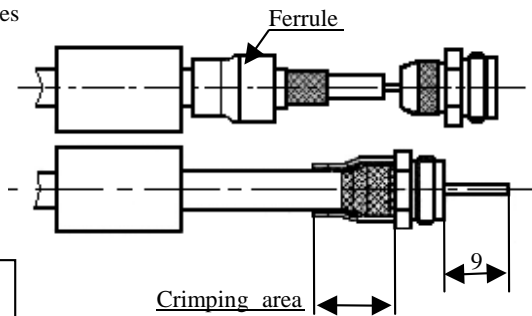

3

Cut the dielectric flush to crimp sleeve.  
Mount insulator against crimp sleeve.

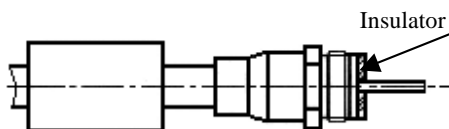

4

Slide the centre contact onto the cable inner conductor against insulator.  
Crimp centre contact with the crimping tool and the positioner.

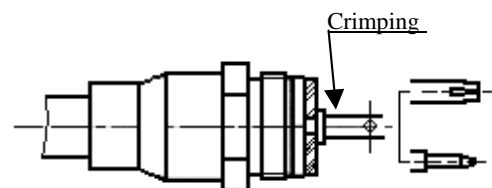

5

Screw sub-a ssembly into the connector body.  
(recommended coupling see the connector TDS)  
Slide sleeve over ferrule and heatshrink sleeve in the place.

