

PAGE 1/2

ISSUE  
**08-02-23C**

SERIES **TNC-COM**

PART NUMBER **R143182161**

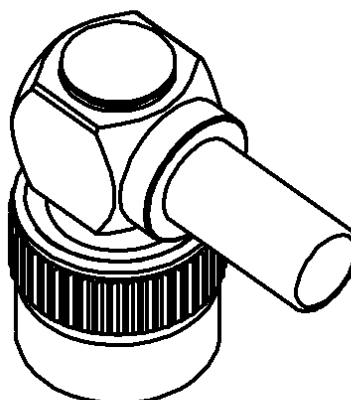
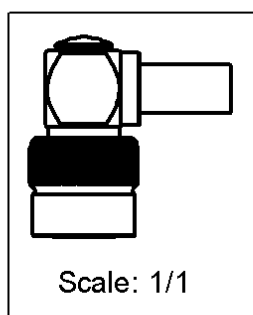
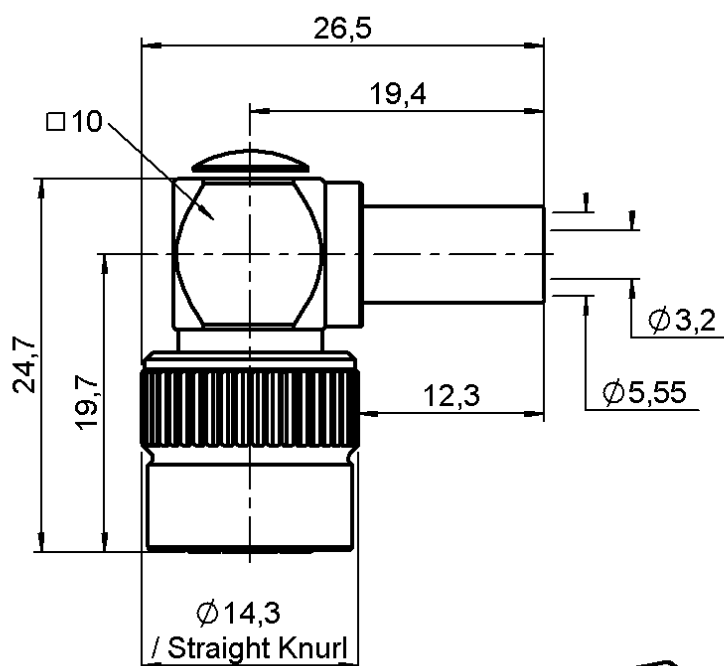

All dimensions are in mm.

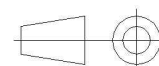

COMPONENTS	MATERIALS	PLATING (μm)
Body	<b>BRASS</b>	<b>NICKEL</b>
Center contact	<b>BRASS</b>	<b>GOLD VOER NICKEL</b>
Outer contact	-	-
Insulator	<b>POLYPROPYLENE</b>	
Gasket	<b>SILICONE RUBBER</b>	
Others parts	<b>BRASS</b>	<b>NICKEL</b>
-	-	-
-	-	-

PAGE 2/2

ISSUE  
08-02-23C

SERIES TNC-COM

PART NUMBER R143182161

## PACKAGING

Standard	Unit	Other
100	Contact us	Contact us

## ELECTRICAL CHARACTERISTICS

Impedance	50	Ω
Frequency	0-1.5	GHz
VSWR	NA + 0	x F(GHz) Maxi
Insertion loss	NA	√F(GHz) dB Maxi
RF leakage	- (NA	- F(GHz)) dB Maxi
Voltage rating	500	Veff Maxi
Dielectric withstanding voltage	1500	Veff mini
Insulation resistance	5000	MΩ mini

## MECHANICAL CHARACTERISTICS

Center contact retention		
Axial force – Mating End	10	N mini
Axial force – Opposite end	10	N mini
Torque	NA	N.cm mini

Recommended torque		
Mating	NA	N.cm
Panel nut	NA	N.cm
Clamp nut	NA	N.cm
A/F clamp nut	0	mm

Mating life	100	Cycles mini
Nominal Weight (Add +15% for max weight)	16,75	g

## ENVIRONMENTAL

Operating temperature	-35/+70	°C
Hermetic seal	NA	Atm.cm3/s
Panel leakage	NA	

## SPECIFICATION

## CABLE ASSEMBLY

Stripping mm	a	b	c	d	e	f
	2	7,5	16	0	14	0

Assembly instruction: **Crimp 05**

Recommended cable(s)

**RG 58**  
**KX 15**  
**RG 141**

Characteristics indicated on this data sheet are those that can be achieved with the highest performance cable. Intrinsic limitations of the cable may diminish the performance of the assembly

Cable retention

- pull off	90	N mini
- torque	NA	N.cm

## TOOLING

Part Number	Description	Other
R282223000	CRIMPING TOOL HEX 1.73-5.41-6.48	5.41
R282235011	MACH SERT. M22520/5-11	5.40
R282293000	PINCE SERT M 22520/5-01	-

## OTHER CHARACTERISTICS