

PAGE 1/2	ISSUE 10-06-15C	SERIES SMA3.5	PART NUMBER R127900001
----------	-----------------	---------------	------------------------

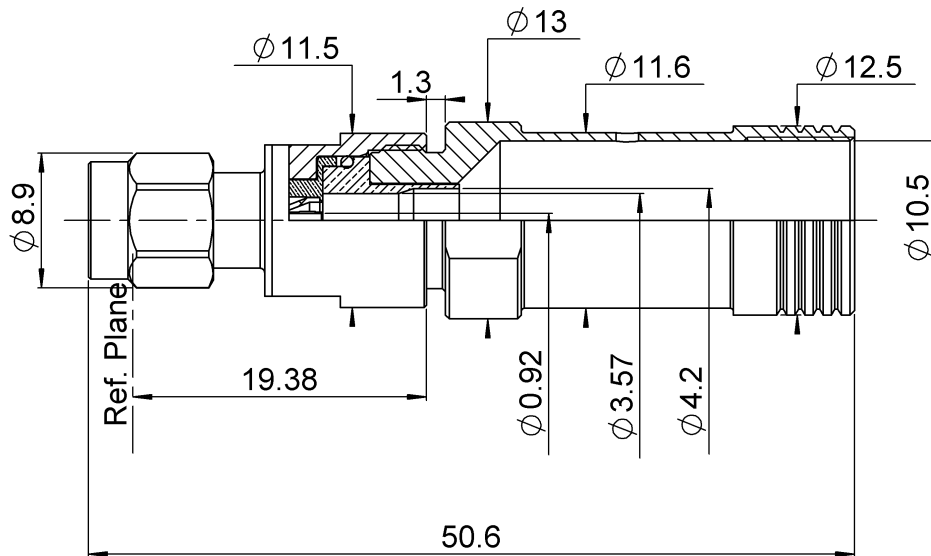

**Aspect brillant
Shiny aspect**

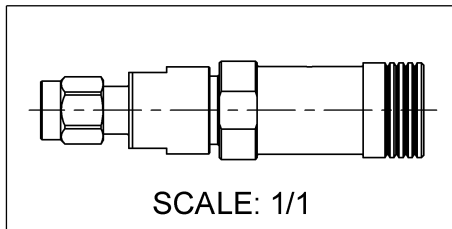
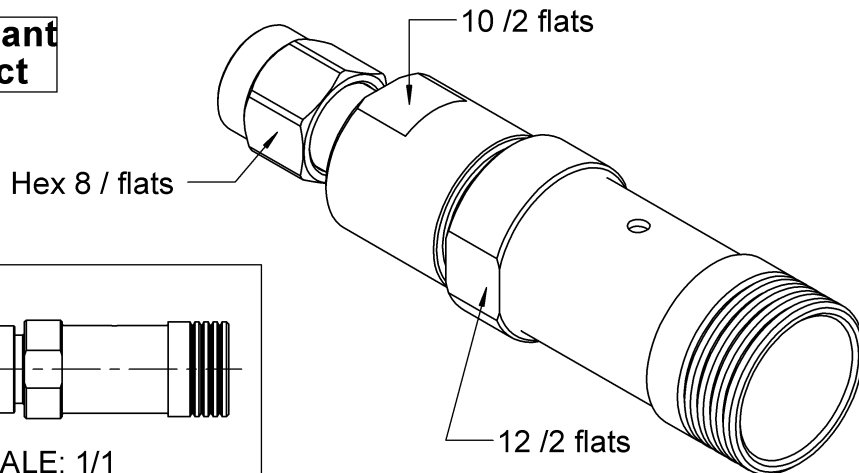

All dimensions are in mm.

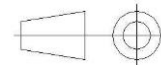

COMPONENTS	MATERIALS	PLATING (µm)
Body	STAINLESS STEEL	PASSIVATED
Center contact	BRASS	OR 1.3 OVER NICKEL PHOSPHORUS 2
Outer contact	-	-
Insulator	PEEK	
Gasket	FLUOROSILICON	
Others parts	BRASS	GOLD 0.2 OVER NICKEL 2
-	-	-
-	-	-

PAGE 2/2	ISSUE 10-06-15C	SERIES SMA3.5	PART NUMBER R127900001
-----------------	------------------------	----------------------	-------------------------------

PACKAGING

Standard	Unit	Other
1	Contact us	Contact us

ELECTRICAL CHARACTERISTICS

Impedance	50	Ω
Frequency	DC-26.5	GHz
VSWR	1.13 + 0,0000	x F(GHz) Maxi
Insertion loss	0.07	\sqrt{F} (GHz) dB Maxi
RF leakage	- (*90)	- F(GHz)) dB Maxi
Voltage rating	350	Veff Maxi
Dielectric withstanding voltage	750	Veff mini
Insulation resistance	5000	M Ω mini

MECHANICAL CHARACTERISTICS

Center contact retention		
Axial force – Mating End	50	N mini
Axial force – Opposite end	50	N mini
Torque	NA	N.cm mini
Recommended torque		
Mating	100	N.cm
Panel nut	NA	N.cm
Clamp nut	170	N.cm
A/F clamp nut	12,0000	mm
Mating life	5000	Cycles mini
Weight	17,5200	g

ENVIRONMENTAL

Operating temperature	-55/+125	$^{\circ}\text{C}$
Hermetic seal	NA	Atm.cm3/s
Panel leakage	IP67	

SPECIFICATION

CABLE ASSEMBLY

Stripping	a	b	c	d	e	f
mm	4,5	0	0	0	0	0

Assembly instruction:

Recommended cable(s)

SHF3M TM

Characteristics indicated on this data sheet are those that can be achieved with the highest performance cable. Intrinsic limitations of the cable may diminish the performance of the assembly

Cable retention

- pull off	**	N mini
- torque	NA	N.cm

TOOLING

Part Number	Description	Hexagon
.	.	.

OTHER CHARACTERISTICS

- * 90 dB from 0.5 at 18 GHz
- ** See TDS of the cable assembly