

**PROTECTION MALE CAP**

**R124.802.108**

Series : SMA-COM

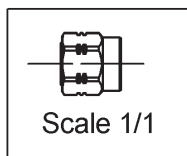
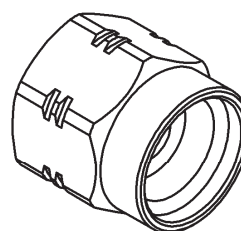
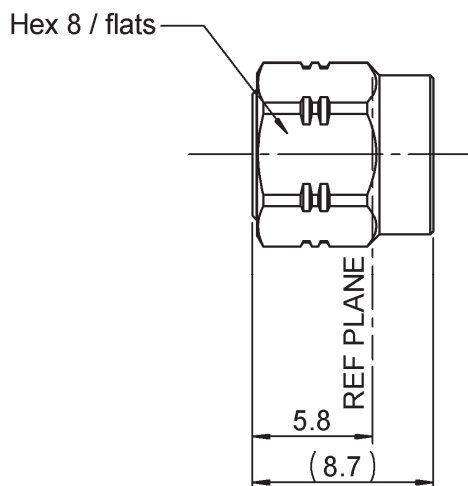

All dimensions are in mm.

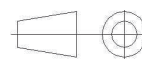

COMPONENTS	MATERIALS	PLATING (µm)
BODY	BRASS	TIN OVER NICKEL
CENTER CONTACT		
OUTER CONTACT		
INSULATOR		
GASKET	SILICONE RUBBER	
OTHERS PARTS	BRASS	TIN OVER NICKEL
-	-	-
-	-	-

Issue : 1151 A

In the effort to improve our products, we reserve the right to make changes judged to be necessary.



**PROTECTION MALE CAP**

**R124.802.108**

Series : SMA-COM

**PACKAGING**

Standard	Unit	Other
<b>100</b>	-	<b>Contact us</b>

**SPECIFICATION**

**ELECTRICAL CHARACTERISTICS**

Impedance	NA	$\Omega$
Frequency	NA	GHz
VSWR	NA + <b>0.0000</b>	x F(GHz) Maxi
Insertion loss	NA	$\sqrt{F}$ (GHz) dB Maxi
RF leakage	- ( NA	- F(GHz)) dB Maxi
Voltage rating	NA	Veff Maxi
Dielectric withstanding voltage	NA	Veff mini
Insulation resistance	NA	M $\Omega$ mini

**ENVIRONMENTAL**

Operating temperature	<b>-65/+165</b>	$^{\circ}$ C
Hermetic seal	NA	Atm.cm3/s
Panel leakage	NA	

**OTHER CHARACTERISTICS**

Assembly instruction

Others :

**MECHANICAL CHARACTERISTICS**

Center contact retention		
Axial force – Mating end	NA	N mini
Axial force – Opposite end	NA	N mini
Torque	NA	N.cm mini
Recommended torque		
Mating	NA	N.cm
Panel nut	NA	N.cm
Mating life	<b>500</b>	Cycles mini
Weight	<b>2.4000</b>	g

Issue : 1151 A

In the effort to improve our products, we reserve the right to make changes judged to be necessary.

