

PAGE 1/4	ISSUE 15-05-15D	SERIES WQMA	PART NUMBER R123W154000
----------	-----------------	-------------	-------------------------

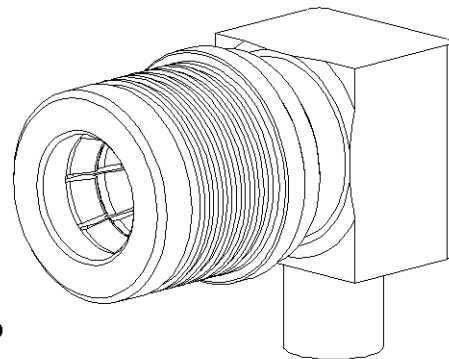

All dimensions are in mm.

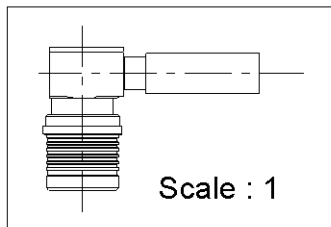
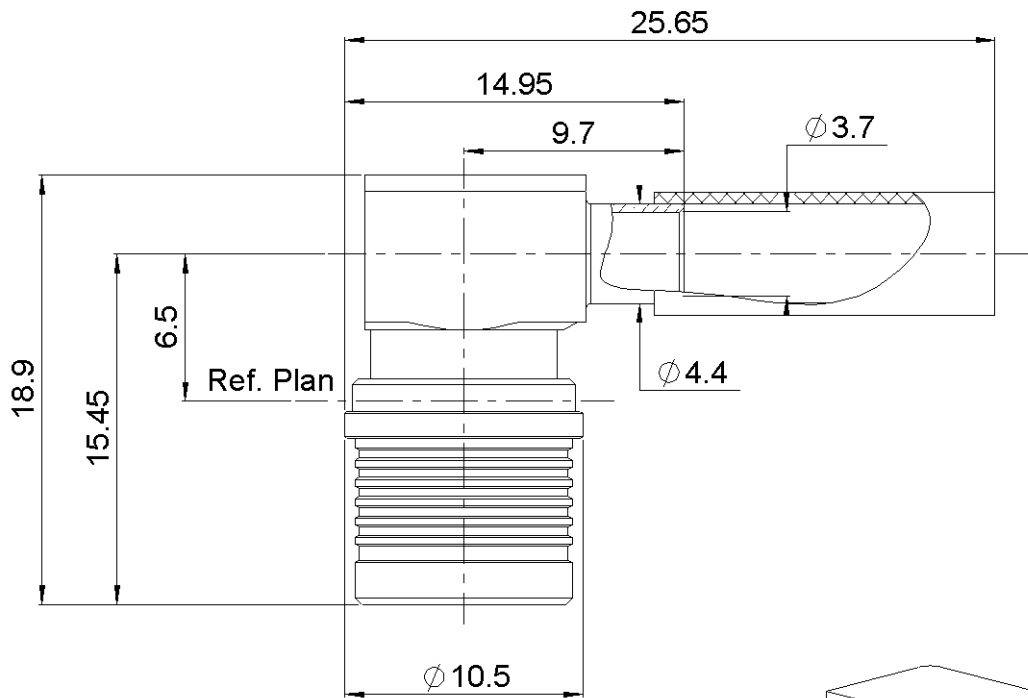
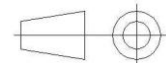

COMPONENTS	MATERIALS	PLATING ( $\mu\text{m}$ )
Body	<b>BRASS</b>	<b>BBR</b>
Center contact	<b>BRASS</b>	<b>NPGR</b>
Outer contact	<b>BRONZE</b>	<b>BBR</b>
Insulator	<b>PTFE</b>	
Gasket	<b>SILICONE RUBBER</b>	
Others parts	<b>BRASS</b>	<b>BBR</b>
-	-	-
-	-	-

PAGE 2/4	ISSUE 15-05-15D	SERIES WQMA	PART NUMBER R123W154000
----------	-----------------	-------------	-------------------------

### PACKAGING

Standard	Unit	Other
100	Contact us	Contact us

### ELECTRICAL CHARACTERISTICS

Impedance		<b>50</b>	Ω
Frequency		<b>0-6</b>	GHz
VSWR	<b>1.02</b>	<b>+</b>	<b>0.0200</b> x F(GHz) Maxi
Insertion loss		<b>0.05</b>	√F(GHz) dB Maxi
RF leakage	- (	<b>***80</b>	- F(GHz)) dB Maxi
Voltage rating		<b>335</b>	Veff Maxi
Dielectric withstanding voltage		<b>1000</b>	Veff mini
Insulation resistance		<b>5000</b>	MΩ mini

### MECHANICAL CHARACTERISTICS

Center contact retention			
Axial force – Mating End		<b>18</b>	N mini
Axial force – Opposite end		<b>27</b>	N mini
Torque		<b>NA</b>	N.cm mini
Recommended torque			
Mating		<b>NA</b>	N.cm
Panel nut		<b>NA</b>	N.cm
Clamp nut		<b>NA</b>	N.cm
A/F clamp nut		<b>0.0000</b>	mm
Mating life	<b>100</b>		Cycles mini
Weight	<b>8.0900</b>		g

### ENVIRONMENTAL

Operating temperature	<b>-40/+105</b>	°C
Hermetic seal	<b>NA</b>	Atm.cm3/s
Panel leakage	<b>NA</b>	

### SPECIFICATION

### CABLE ASSEMBLY

Stripping	a	b	c	d	e	f
mm	<b>3.17</b>	<b>0</b>	<b>0</b>	<b>0</b>	<b>0</b>	<b>0</b>
mm	<b>3.17</b>	<b>0</b>	<b>14*</b>	<b>0</b>	<b>0</b>	<b>0</b>

\* for jacketed cable

Assembly instruction: **NA**

Recommended cable(s)

**RG 402**

**KS 2**

**CONF FIL2PA373**

Characteristics indicated on this data sheet are those that can be achieved with the highest performance cable. Intrinsic limitations of the cable may diminish the performance of the assembly

Cable retention

- pull off	<b>270</b>	N mini
- torque	<b>NA</b>	N.cm

### TOOLING

Part Number	Description	Hexagon
R282053000	STRIPPING TOOL	
R282067000	POINTER GAUGE	
R282740000	SOLDERING MOUNTING	
R282744240	SOLDERING POSITIONER	
R282761000	ASSEMBLY FIXTURE FOR	WQMA END CAP

### OTHER CHARACTERISTICS

**\*Interface ingress protection: IP68 (IEC60529) mated condition**

**\*\*Intermod.: -120dBc at 1.8GHz (2 x 20W)**

**\*\*\*RF leakage(interface) 3<F<6GHz: >70dB**

PAGE 3/4	ISSUE 15-05-15D	SERIES WQMA	PART NUMBER R123W154000
----------	-----------------	-------------	-------------------------

## POWER DERATING

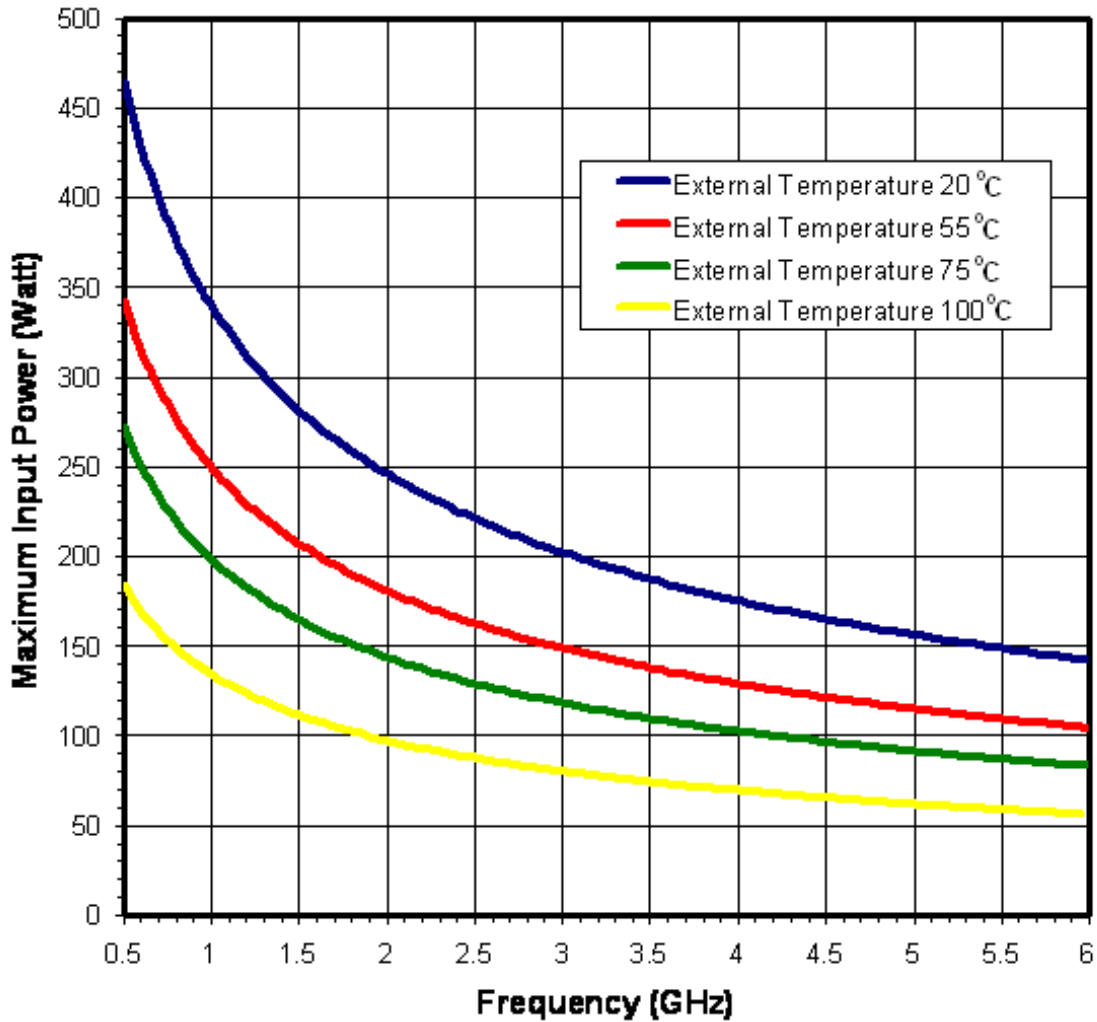

PAGE 4/4	ISSUE 15-05-15D	SERIES WQMA	PART NUMBER R123W154000
----------	-----------------	-------------	-------------------------

**COMPONENTS**

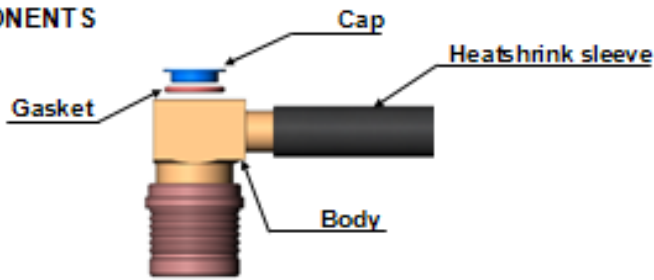

**STRIPPING DIMENSIONS**

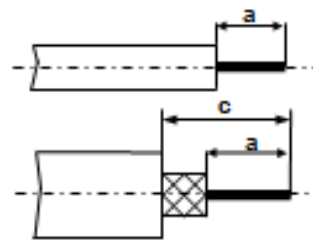

We recommend a cable thermal preconditioning before assembly

**1**

For cables with a jacket, remove this one according to the quotation C before using the recommended tool. Insert the cable into the clamping element. Present the pointer in front of the clamping element. Push the cable until it stops, while holding the clamping element pushed on the hollow part of the pointer. Turn the clamping part until the release of the pointer.

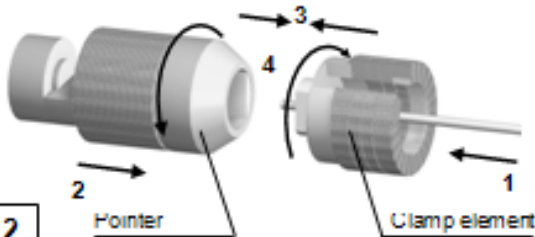

**4**

Put three rings of solder around the cable. Solder the body onto the cable.

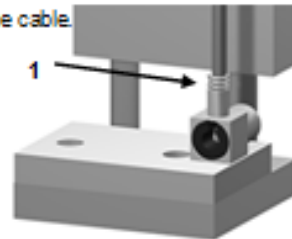

**2**

Present the cutting element in front of the cutting element. Push and turn both elements, back part opposite to the front part. Once they reach the stop, pull without revolving.

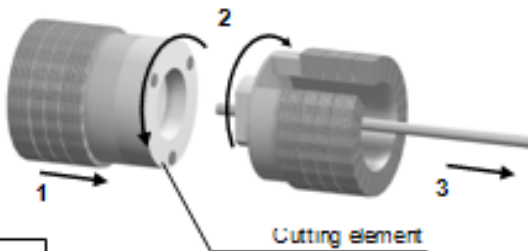

**5**

After cooling, remove the assembly from the jig. Remove the positioner. Solder the inner conductor.

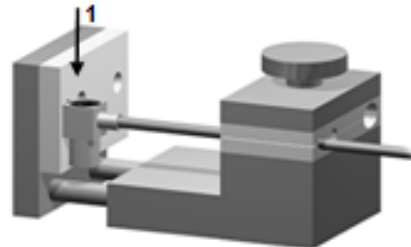

**3**

Insert the cable into the body. Secure the positioner into the assembly jig. Place the sub-assembly into the assembly jig. Tighten.

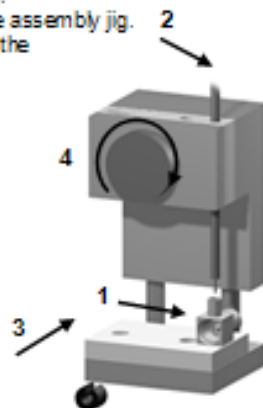

**6**

Place the connector into the tool. Place the gasket and the cap into the body. Press on the cap flush or slightly below the surface of the body assembly. Slide the sleeve over the body and heatshrink it in place.

