

PAGE 1/4	ISSUE 20-03-17E	SERIES SBMA	PART NUMBER R108294000
----------	-----------------	-------------	------------------------

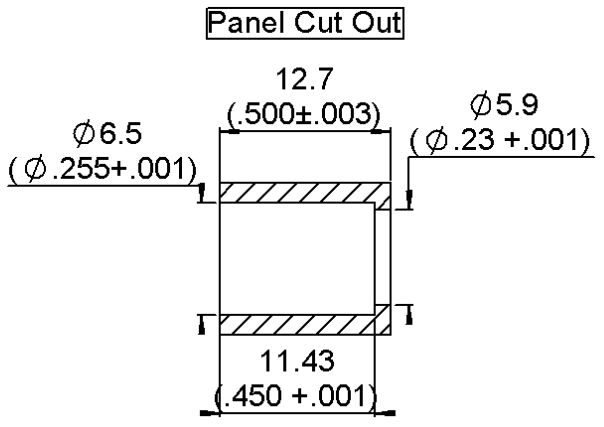

All dimensions are in mm.

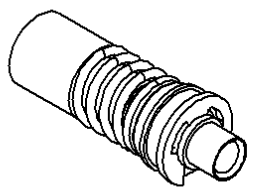
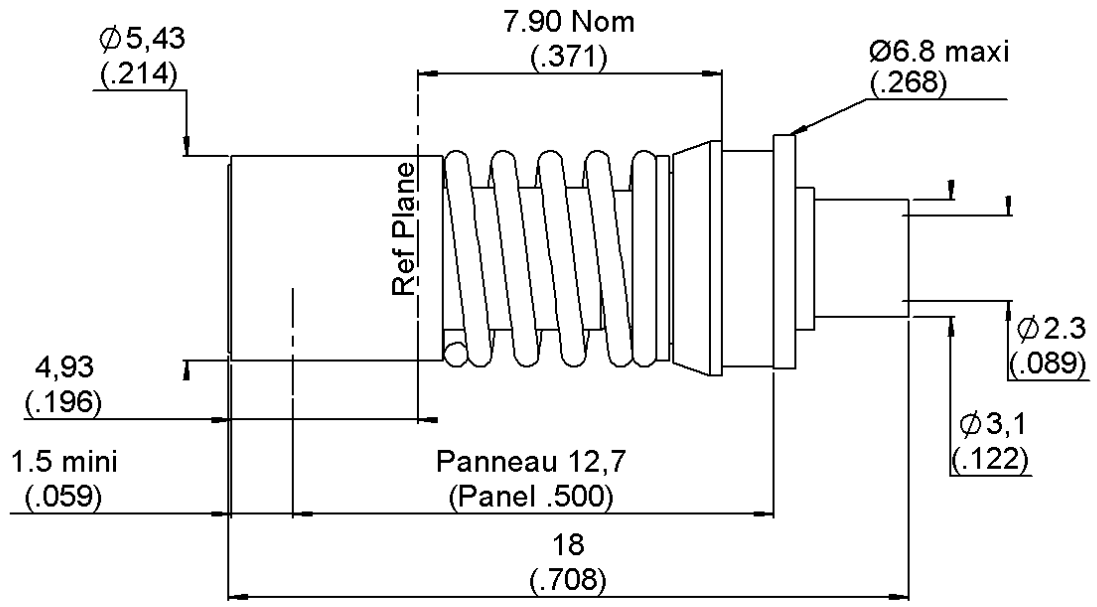
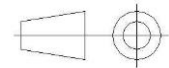

COMPONENTS	MATERIALS	PLATING (µm)
Body	<b>STAINLESS STEEL</b>	<b>GOLD OVER NICKEL</b>
Center contact	<b>BERYLLIUM COPPER</b>	<b>GOLD OVER NICKEL</b>
Outer contact	<b>BERYLLIUM COPPER</b>	<b>GOLD OVER NICKEL</b>
Insulator	<b>PTFE</b>	
Gasket	-	
Others parts	<b>BERYLLIUM COPPER</b>	<b>NICKEL</b>
-	-	-
-	-	-

PAGE <b>2/4</b>	ISSUE <b>20-03-17E</b>	SERIES <b>SBMA</b>	PART NUMBER <b>R108294000</b>
-----------------	------------------------	--------------------	-------------------------------

**PACKAGING**

Standard	Unit	Other
<b>1</b>		<b>Contact us</b>

**ELECTRICAL CHARACTERISTICS**

Impedance	<b>50</b>	Ω
Frequency	<b>0-28</b>	GHz
VSWR	<b>1.05 + 0,0100</b>	x F(GHz) Maxi
Insertion loss	<b>.04</b>	√F(GHz) dB Maxi
RF leakage	<b>90</b>	- F(GHz)) dB Maxi
Voltage rating	<b>250</b>	Veff Maxi
Dielectric withstanding voltage	<b>675</b>	Veff mini
Insulation resistance	<b>5000</b>	MΩ mini

**MECHANICAL CHARACTERISTICS**

Center contact retention		
Axial force – Mating End	<b>18.1</b>	N mini
Axial force – Opposite end	<b>18.1</b>	N mini
Torque	<b>NA</b>	N.cm mini
Recommended torque		
Mating	<b>NA</b>	N.cm
Panel nut	<b>NA</b>	N.cm
Clamp nut	<b>NA</b>	N.cm
A/F clamp nut	<b>0,0000</b>	mm
Mating life	<b>1000</b>	Cycles mini
Weight	<b>1,6000</b>	g

**ENVIRONMENTAL**

Operating temperature	<b>-65/+105</b>	°C
Hermetic seal	<b>NA</b>	Atm.cm3/s
Panel leakage	<b>NA</b>	

**SPECIFICATION**

**CABLE ASSEMBLY**

Stripping	a	b	c	d	e	f
mm	<b>1,78</b>	<b>0</b>	<b>0</b>	<b>0</b>	<b>0</b>	<b>0</b>

Assembly instruction:

Recommended cable(s)

**KS 1**  
**RG 405**

Characteristics indicated on this data sheet are those that can be achieved with the highest performance cable. Intrinsic limitations of the cable may diminish the performance of the assembly

Cable retention

- pull off	<b>200</b>	N mini
- torque	<b>NA</b>	N.cm

**TOOLING**

Part Number	Description	Hexagon
R282051000	STRIPPING TOOL	Denudage
R282062000	POINTER GAUGE	Appointage (ame cable)
R282740000	SOLDERING MOUNTING	Soudure (support)

**OTHER CHARACTERISTICS**

-

PAGE 3/4	ISSUE 20-03-17E	SERIES SBMA	PART NUMBER R108294000
----------	-----------------	-------------	------------------------

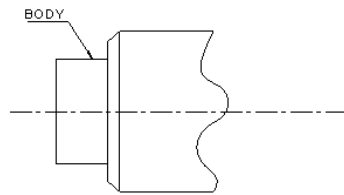

We recommend a cable thermal preconditioning before assembly

**1**  
**1-1** strip the cable.  
 Stripping tool R282.051.000  
 Positioner R282.062.000

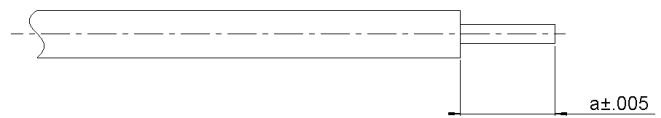

Stripping	a	b	c	d	e
inch	.070	-	-	-	-
mm	1.78	-	-	-	-

**2**  
**2-1** Trim cable centre conductor  
 Trimmer R282.062.000

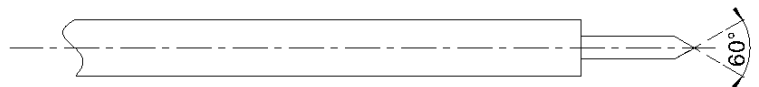

**3**  
**3-1** Introduce the cable into the Connector body until contact with the Body shoulder. Place the sub assembly into the assembly Jip R282.740.000 (or equivalent) with positioner R282.860.120 and tighten it.  
**3-2** Solder body on the cable.  
**3-3** Let the assembly cool down before Removing it from the Jig.

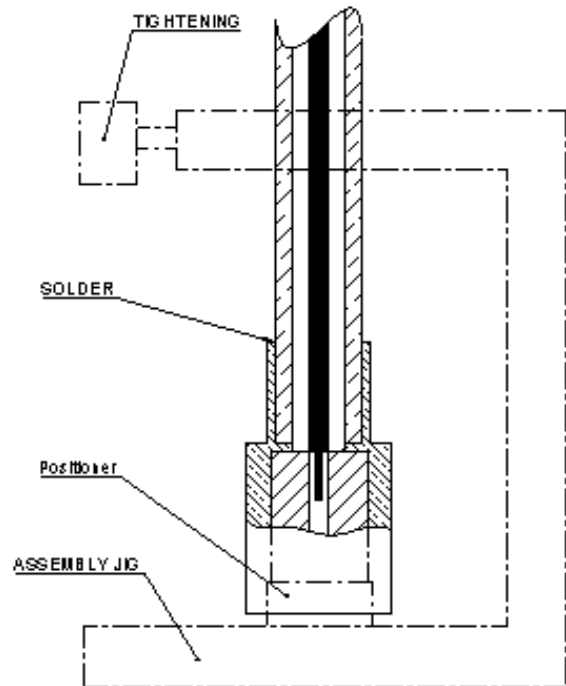

PAGE 4/4	ISSUE 20-03-17E	SERIES SBMA	PART NUMBER R108294000
----------	-----------------	-------------	------------------------

