

PAGE 1/3	ISSUE 29-08-25A	SERIES IMP SR	PART NUMBER R107825050
----------	--------------------	---------------	------------------------

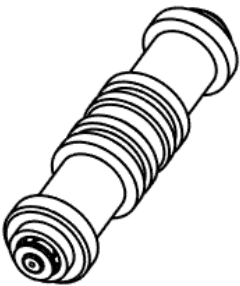

All dimensions are in mm. Tolerances according ISO 2768 m-H

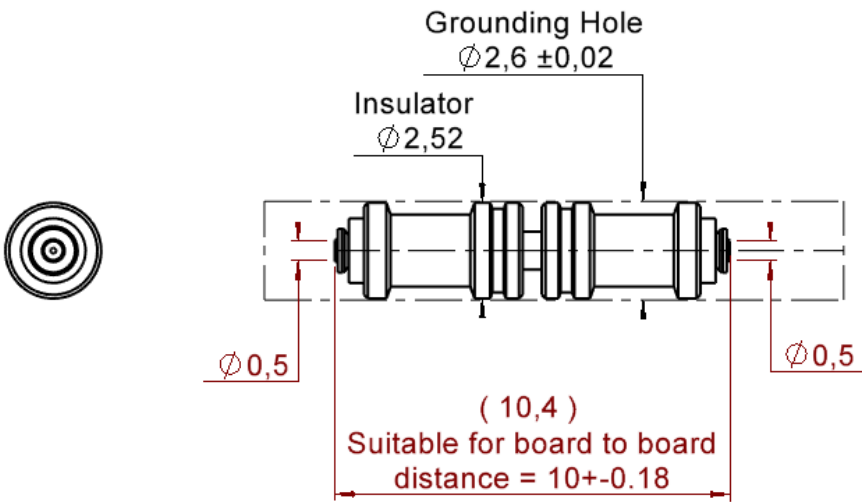
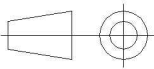

COMPONENTS	MATERIALS	PLATING (μm)
Body	BERYLLIUM COPPER - BRONZE	NPGR
Center contact		
Outer contact	PTFE	
Insulator		
Gasket		
Others parts		
-	-	-
-	-	-

PAGE 2/3

ISSUE
29-08-25A

SERIES IMP SR

PART NUMBER R107825050

PACKAGING

Standard	Unit	Other
100	Contact us	Contact us

ELECTRICAL CHARACTERISTICS

Impedance	50	Ω
Frequency	0-40	GHz
VSWR	* + 0,0000	x F(GHz) Maxi
Insertion loss	-0.035**	√F(GHz) dB Maxi
RF leakage	- (NA	- F(GHz) dB Maxi
Voltage rating	225	Veff Maxi
Dielectric withstanding voltage	500	Veff mini
Insulation resistance	1000	MΩ mini

ENVIRONMENTAL

Operating temperature	-55/+165	°C
Hermetic seal		Atm.cm3/s
Panel leakage		

MECHANICAL CHARACTERISTICS

Center contact retention		
Axial force – Mating End	0.25	N mini
Axial force – Opposite end	0.25	N mini
Torque	NA	N.cm mini

Recommended torque		
Mating	NA	N.cm
Panel nut	NA	N.cm

Mating life	50	Cycles mini
Nominal Weight	0,1000	g
(Add +15% for max weight)		

SPECIFICATION

OTHER CHARACTERISTICS

Assembly instruction:

Others:

* VSWR Typical:1,20 DC-30GHz/ 1.3 at 30->40Ghz

Value gated with coaxial measurement tool in nominal position
Coaxial Line Only

Value for connector only estimated from measurement :
Insertion Loss with coaxial measurement tool in nominal position

**Insertion Loss: -0.02-0.11√F(GHz) dB Maxi

PCB Layouts
Dimension are given for information

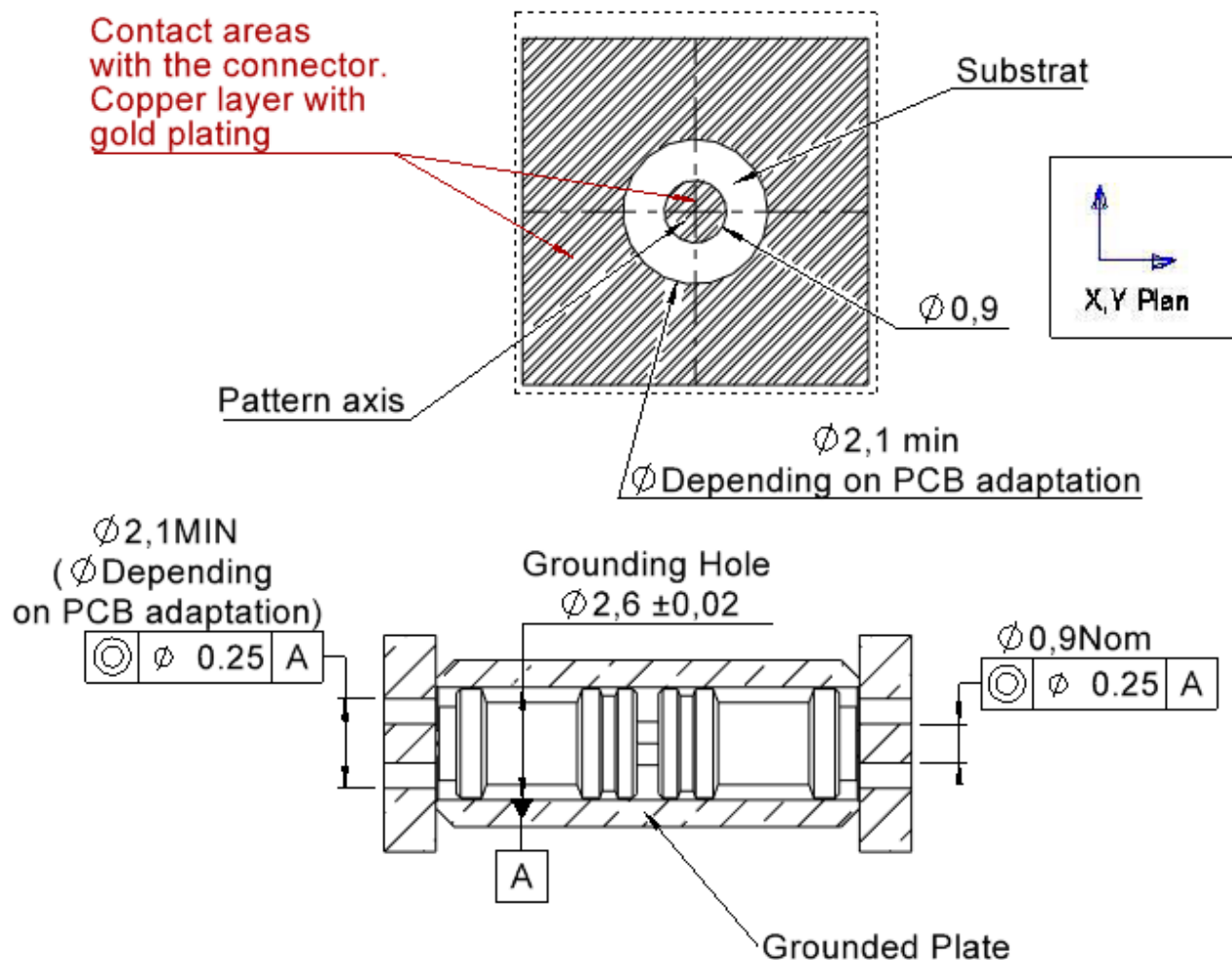

**The misalignment between the connector axis and the PCB
can't exceed a coaxiality default of 0.25 mm (X,Y plan)**