

**STRAIGHT PLUG SOLDER TYPE
WITH COMPOUND CHAMBER**

CABLE SHF 8+8M

M125.068.L04

Series : SMA

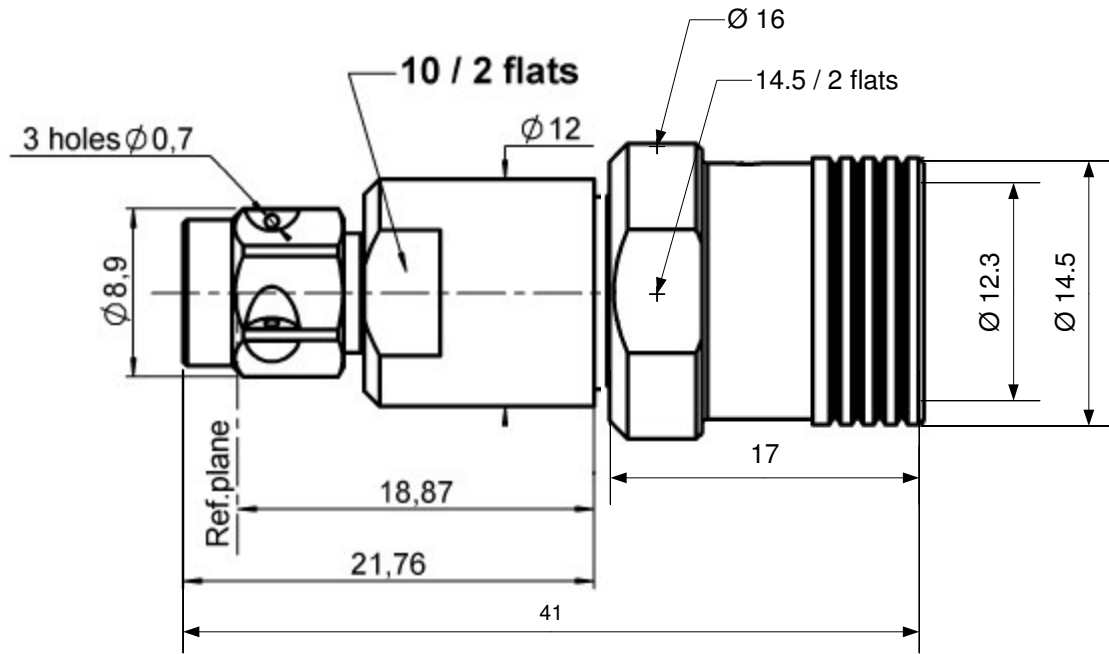

All dimensions are in mm.

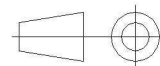

COMPONENTS	MATERIALS	PLATINGS (µm)
BODY	STAINLESS STEEL (316L)	PASSIVATED
CENTER CONTACT	BERYLLIUM COPPER	GOLD 1.3 OVER NICKEL 2
OUTER CONTACT	-	-
INSULATOR	PTFE	-
GASKET	FLUOROSILICON	-
OTHERS PARTS	ST. STEEL (316L), BRASS	GOLD PASSIVATED
-	-	-
-	-	-

Issue : 0608 A

In the effort to improve our products, we reserve the right to make changes judged to be necessary.



RADIALL®

**STRAIGHT PLUG SOLDER TYPE
WITH COMPOUND CHAMBER
CABLE SHF 8+8M**

M125.068.L04

Series : SMA

PACKAGING

Standard	Unit	Other
100	'W' option	Contact us

SPECIFICATION

ELECTRICAL CHARACTERISTICS

Impedance	50	Ω
Frequency	0-18	GHz
VSWR	1.15 + 0,0000	x F(GHz) Maxi
Insertion loss	0.1	\sqrt{F} (GHz) dB Maxi
RF leakage	- (90)	- F(GHz)) dB Maxi
Voltage rating	335	Veff Maxi
Dielectric withstanding voltage	1000	Veff mini
Insulation resistance	5000	M Ω mini

CABLE ASSEMBLY

Stripping	a	b	c	d	e	f
mm	20,0	2,50	0,00	0,00	0,00	0,00

Assembly instruction :

Recommended cable(s)
F1703-197
F1703-160

Characteristics indicated on this data sheet are those that can be achieved with the highest performance cable. Intrinsic limitations of the cable may diminish the performance of the assembly

Cable retention

- pull off * N mini
- torque NA N.cm

MECHANICAL CHARACTERISTICS

Center contact retention		
Axial force – Mating end	27	N mini
Axial force – Opposite end	27	N mini
Torque	NA	N.cm mini

TOOLING

Part Number	Description	Hexagon
.	.	.

Recommended torque		
Mating	110	N.cm
Panel nut	NA	N.cm
Clamp nut	300	N.cm
A/F clamp nut	11,0000	mm

Mating life	500	Cycles mini
Weight	21,6927	g

OTHERS CHARACTERISTICS

* See the TDS cable assembly

ENVIRONMENTAL

Operating temperature	-65/+165	$^{\circ}\text{C}$
Hermetic seal	NA	Atm.cm3/s
Panel leakage	IP67	

Issue : **0608 A**

In the effort to improve our products, we reserve the right to make changes judged to be necessary.



RADIALL®