

PROPRIETARY INFORMATION  
 NOT TO BE RELEASED  
 WITHOUT WRITTEN PERMISSION  
 FROM AN AUTHORIZED  
 REPRESENTATIVE OF  
 APPLIED ENGINEERING PRODUCTS

REVISIONS			
REV.	DESCRIPTION	DATE	APPROVED
A	INITIAL RELEASE	08/23/07	K.P.

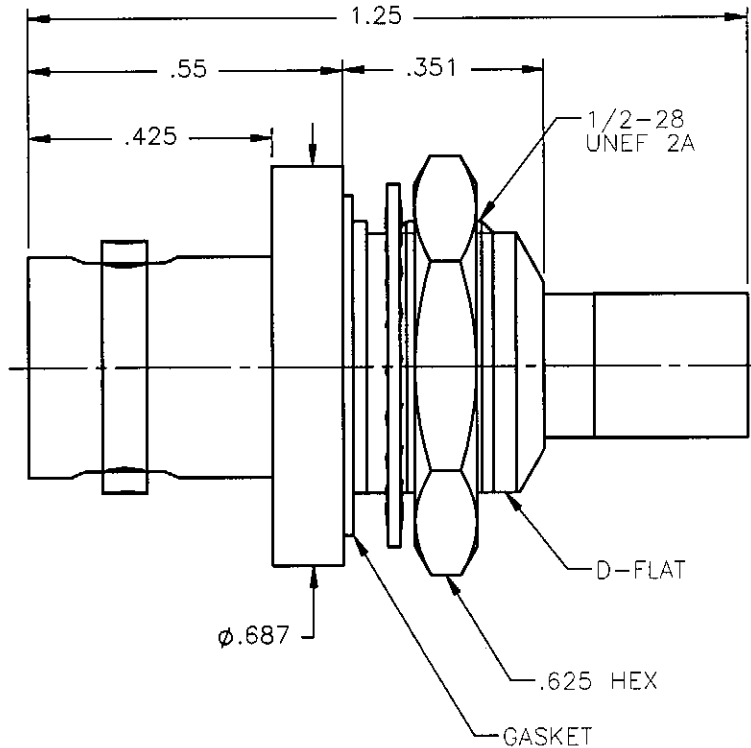

**NOTES:**

**MATERIALS:**

1. INSULATORS = VIRGIN WHITE TEFLON PER ASTM D1710, GRADE 1, TYPE I, CLASS "B".
2. CONTACTS 'SMB & BNC', SPRING = BERYLLIUM COPPER PER ASTM B196, ALLOY C17300, TEMPER TD04.
3. LOCKWASHER = PHOSPHOR BRONZE PER ASTM B139, COPPER ALLOY C53400, TEMPER H04.
4. GASKET = SILICON RUBBER 45-55 DUROMETER DOW CORNING SILASTIC 250.
5. SLEEVE = BRASS PER ASTM B16 ALLOY C36000 TEMPER H02, BRASS TO BE SPEC'D. @ 75-82 ROCKWELL "B" TENSILE STRENGTH 55-65 KPSI.
6. ALL OTHER METAL PARTS = BRASS PER ASTM B16 ALLOY C36000 TEMPER H02.

**FINISHES:**

1. CONTACTS = GOLD PLATE PER MIL-G-45204, TYPE II, CLASS 1, GRADE C, OVER .00010 TO .00020 STRESS FREE SULFAMATE NICKEL PER QQ-N-290.
2. ALL OTHER METAL PARTS = NICKEL PLATE PER QQ-N-290, CLASS 1, GRADE G, EXCEPT .0001 TO .0002 THICK OVER .00005 TO .0001 THICK COPPER PER MIL-C-14550.

UNLESS OTHERWISE SPECIFIED DIMENSIONS ARE IN INCHES TOLERANCES ON		DWN: K.P.	DATE: 08/23/07	<b>APPLIED ENGINEERING PRODUCTS</b> 104 John W. Murphy Dr. New Haven, CT 06513
DECIMAL	ANGLE	CHKD: A.D.M.	DATE: 08/23/07	
		APVD: J.M.	DATE: 08/23/07	
REFERENCE:		MATERIALS & FINISHES: SEE NOTES		<b>BNC BULKHEAD FEMALE JACK TO SMB FEMALE PLUG ADAPTER</b>
ORIGINATED: K.P. DATE: 08/23/07		SIZE: A	FSCM NO.: 19505	DWG NO.: 5513-7501-000 SCALE: 3:1 THIRD ANGLE PROJECTION
				REV: A SHEET 1 OF 1

5513-7501-000