

| | | | | |
|---|--|--------------------|------------------------|----------------------|
|  | TECHNICAL DATA SHEET | MICT0400011 | | |
| Series MULTI | SIZE 8 QUADRAX CONTACTS WIRING INSTRUCTIONS FOR NF26Q100 CABLE | | Issue Mar. 09, 2023 | Page 1 / 3 |

1- **OPTIONAL STEP:** If applicable, slide the sealing sleeve over the cable

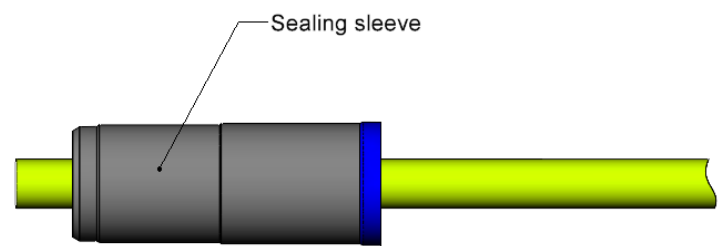

2- Strip the outer jacket and add the heat shrinkable sleeve ASNE0718-03 as illustrated

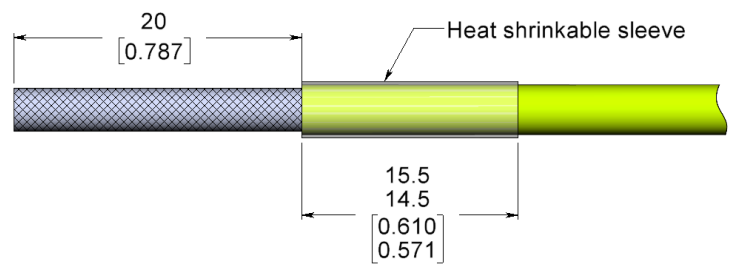

3- Comb the round braid



4- Slide the shield crimp sleeve over the braid against the sheath end cut
Optional: Twist the braid end to facilitate the sliding of the shield crimp sleeve

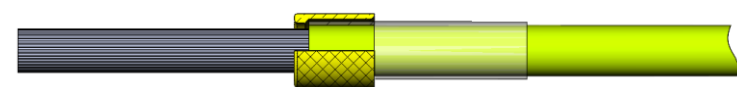

5- Fold back the braid over the shield crimp sleeve and cut the flat shield braid to remove it. Then cut the braid and the 4 conductors as shown:

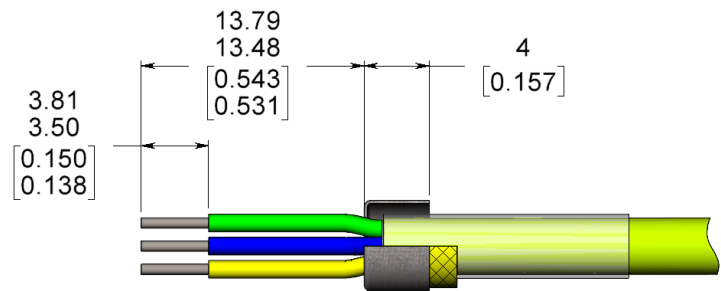

6- Slide the center contacts on the conductors:

- 4 pin center contacts on the quadrax pin contact.
- 4 socket center contacts on the quadrax socket contact.

| | | | | |
|---|-------|-----------|------|----------|
| CREATION NAME : PECAULT B. DATE : Mar. 09, 2023 APPR. :LEGLOAHEC Y. | | | | |
| | | | | |
| | | | | |
| | | | | |
| | ISSUE | REVISIONS | NAME | APPROVED |

- 7-** Crimp the center contacts with the tools:
- Crimping tool: M22520/2-01 (RADIAL P/N 282281) selector 5
 - Positioner: DANIELS K 709 (RADIAL P/N 282581010)

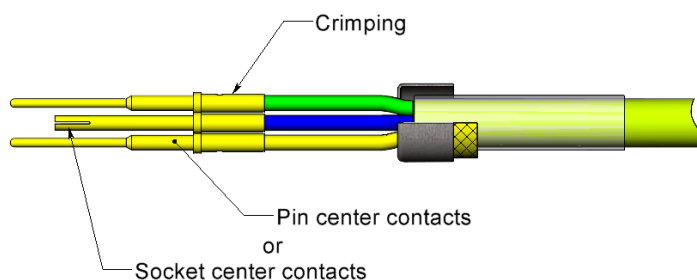

- 8-** The insulator and the spacer have a polarizing keyway. Refer to the standardization regarding the wire colors position to respect, compared to the quadrax keying and put in place the 4 contacts into the slots of the spacer. Then, slide the insulator over the contacts making the polarizing keys coincident

The pin and socket outer contact bodies have an insulator polarizing key. Then, introduce the sub-assembly into the outer contact body making the polarizing keys coincident

For pin contacts:

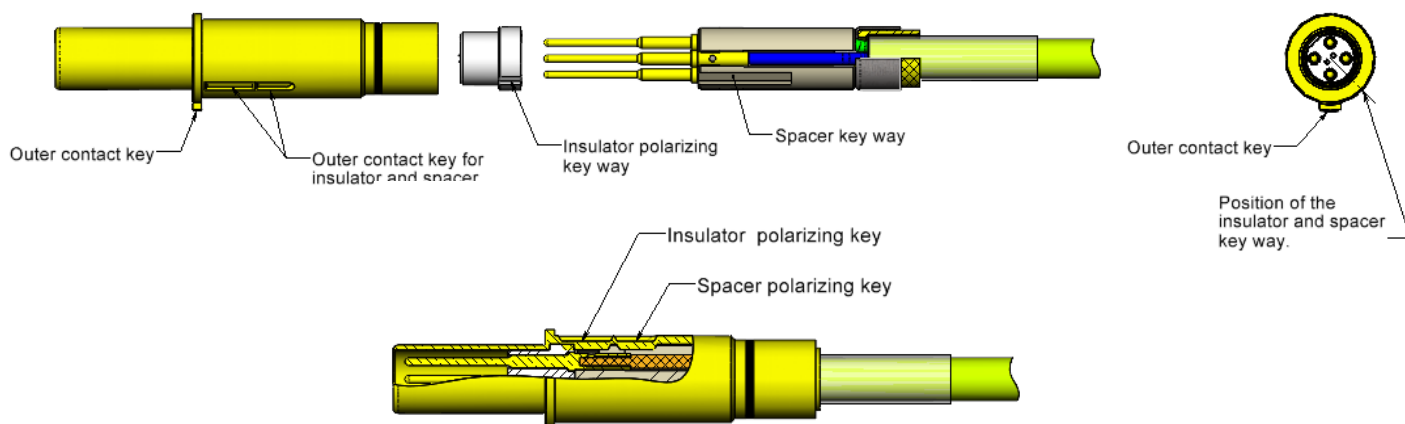

For socket contacts:

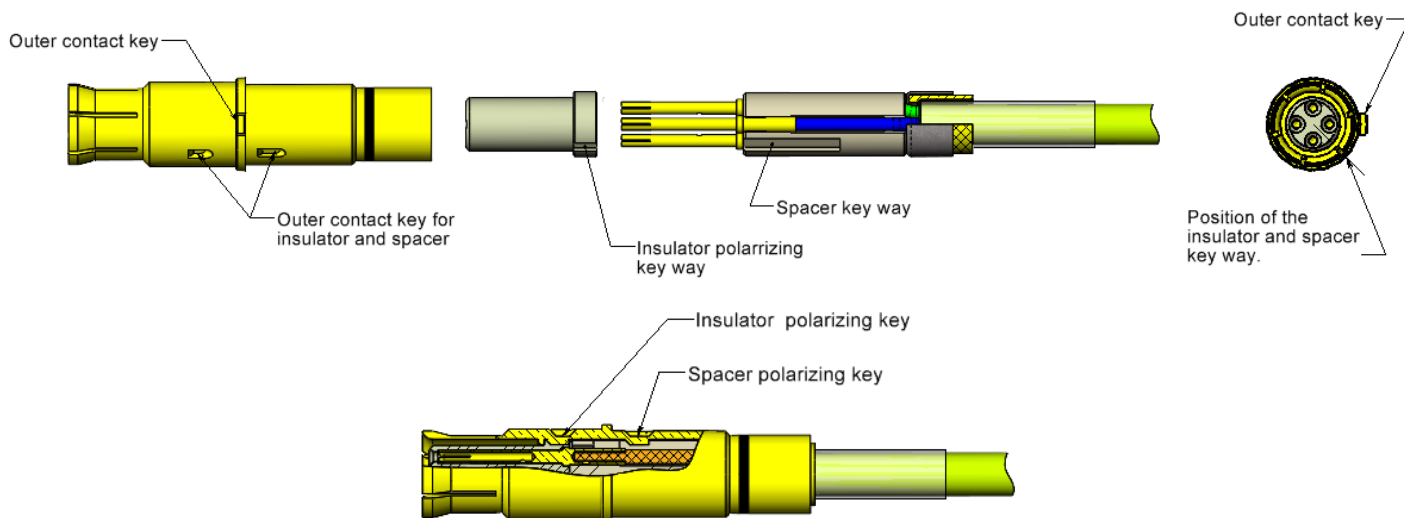

- 9-** Strongly push on the cable while crimping to make sure that the inner parts are well mounted in the outer contact.

Crimp the outer contact body in the indicated area with the tools:

- Crimping tool: M22520/5-01 (RADIALL P/N 282293)
- Die: M22520/5-45 (RADIALL P/N 282236) – Hex die closure B (.218 on flats)

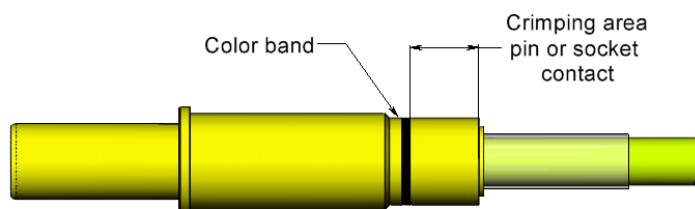

- 10-** Check the dimension after crimping as illustrated

